



1/2, 134 QUEEN MARGARET DRIVE

BOTANICS, GLASGOW

THE PROPERTY

1 | BEDROOM 1 | BATHROOM

1 | PUBLIC ROOM

This superb first floor flat on Queen Margaret Drive has been lovingly renovated by the current owner whilst maintaining a plethora of period features and the original full one- bedroom layout. It is a stone's throw from the botanic gardens, Byres Road and the best of the amenities the West End has to offer.

The building is initially accessed via secure entry system into a well maintained common close with access to a large, residents' shared garden. A small porch area with original Victorian tiles leads to a welcoming reception hall with parquet flooring and excellent sized storage cupboard off. The bright, bay windowed lounge with feature period fireplace has a large cupboard off currently utilised as a very convenient study area. The master bedroom is an excellent size and has a further beautifully restored period fireplace. The impressive dining kitchen has been recently tastefully refitted while retaining the original tenement kitchen range and benefits from a convenient utility area. The accommodation is completed by a striking period-style bathroom with feature stained glass.

The property has gas central heating from a recently installed Vokera boiler and hard-wired smoke alarms to meet current legislation.





First Floor

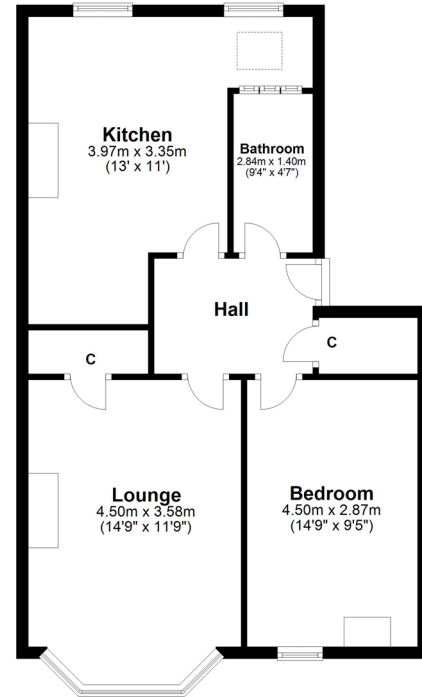

WE4081

Sat Nav: 1/2, 134 Queen Margaret Drive, Botanics, G20 8NY

All measurements and distances are approximate.
Floorplans are for illustration purposes and may not be to scale.

For the full home report visit www.corumproperty.co.uk



corum

WE'RE **SOLD** ON YOUR FUTURE

82 Hyndland Road, G12 9UT

Tel: 0141 357 1888 - Email: westend@corumproperty.co.uk - Fax: 0141 357 1188