



THE PROPERTY

2 | BEDROOMS 1 | BATHROOM
1 | PUBLIC ROOM

A traditional upgraded top floor tenement flat enjoying a lovely position within this locally admired red sandstone B listed building.

Accessed via a secure door entry system and communal residents' stairwell, the total accommodation comprises: entrance vestibule, hallway with store cupboard adjacent, fantastic lounge with aspects to front and side, great sized master bedroom, good second double bedroom, refurbished modern fitted kitchen with ample units and modern bathroom.

The specification includes a system of gas central heating, double glazing, modern carpeting/floor coverings and the subjects are well presented in neutral decorative tones throughout.

Amenities

Netherlee is one of East Renfrewshire's most sought after residential suburbs and is a haven for young growing families enjoying access to some of the best schooling within the West of Scotland, notably within catchment for Netherlee Primary School, OLM, St Ninians and Williamwood Secondary schools. There is a full range of independent retailers including cafes and restaurants, and the district provides swift access via both road and rail to the city centre and beyond. There is a variety of places of worship found within the surrounding area and an array of sports and leisure activities including local parks, health clubs, gyms and golf courses close to hand in addition to equestrian pursuits.



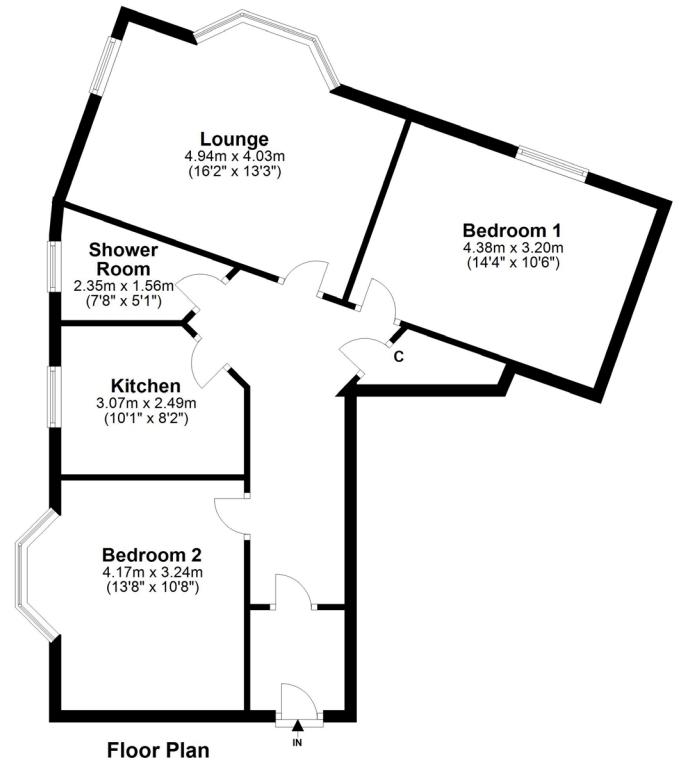

CC0472

Sat Nav: 17 MacLaren Place, Netherlee, G44 3RZ

All measurements and distances are approximate.
Floorplans are for illustration purposes and may not be to scale.

For the full home report visit www.corumproperty.co.uk



WE'RE **SOLD** ON YOUR FUTURE

572 Clarkston Road, G44 3SQ

Tel: 0141 637 6688 - Email: netherlee@corumproperty.co.uk - Fax: 0141 637 9788