



**1/2, 268 CROW ROAD**

**BROOMHILL**

## THE PROPERTY

2 | BEDROOMS     1 | BATHROOM

1 | PUBLIC ROOM

1/2 268 Crow Road is a brilliant, two-bedroom, first floor tenement flat, located right in the heart of the ever-popular Broomhill area. Access to the building is via an immaculate communal hallway with decorative tiling. The internal accommodation comprises: welcoming reception hallway with storage cupboard, bay window lounge with focal fireplace, modern internal kitchen with plentiful supply of base and wall mounted units and two spacious double bedrooms. Finally, there is a stunning family bathroom which completes the accommodation on offer.

The flat has gas central heating, double glazing, secure entry system and communal back gardens.

### Amenities

Broomhill is a beautiful, leafy district in the West End of Glasgow bounded by the districts of Thornwood and Partick to the south, Hyndland to the east, and Jordanhill, Scotstoun and Victoria Park to the west.

Broomhill Primary School is the main feeder school to the state secondary schools in the area, Hyndland Secondary and St Thomas Aquinas.





### First Floor

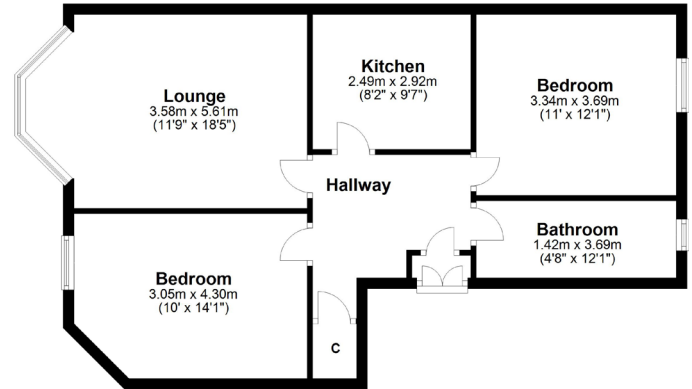

WE4176

Sat Nav: 1/2, 268 Crow Road, Broomhill, G11 7LA

All measurements and distances are approximate.  
Floorplans are for illustration purposes and may not be to scale.

For the full home report visit [www.corumproperty.co.uk](http://www.corumproperty.co.uk)





  
c o r u m

WE'RE **SOLD** ON YOUR FUTURE

82 Hyndland Road, G12 9UT

Tel: 0141 357 1888 - Email: [westend@corumproperty.co.uk](mailto:westend@corumproperty.co.uk) - Fax: 0141 357 1188