



13 WOODFIELD CRESCENT

AYR



c o r u m

www.corumproperty.co.uk



13 WOODFIELD CRESCENT, AYR

2 | BEDROOMS 1 | BATHROOM 1 | PUBLIC ROOM

A rarely available and well-presented ground floor apartment with own front and back doors and suited to a wide range of purchasers.

Number 13 is a ground floor apartment which provides bright and spacious accommodation suited to a variety of potential purchasers including those clients looking for all on the level living within a quiet residential location close to local amenities.

Features and benefits include a modern fitted kitchen, three-piece bathroom, gas central heating, double glazing, fresh carpeting and neutral decoration.

In summary the accommodation extends to a vestibule, reception hallway with storage cupboard off, front facing lounge/dining room, modern fitted kitchen with space for table and chairs and door to the rear garden, two double bedrooms and three-piece bathroom.

Externally the property enjoys front and rear gardens which are predominantly laid to lawn with hedging.



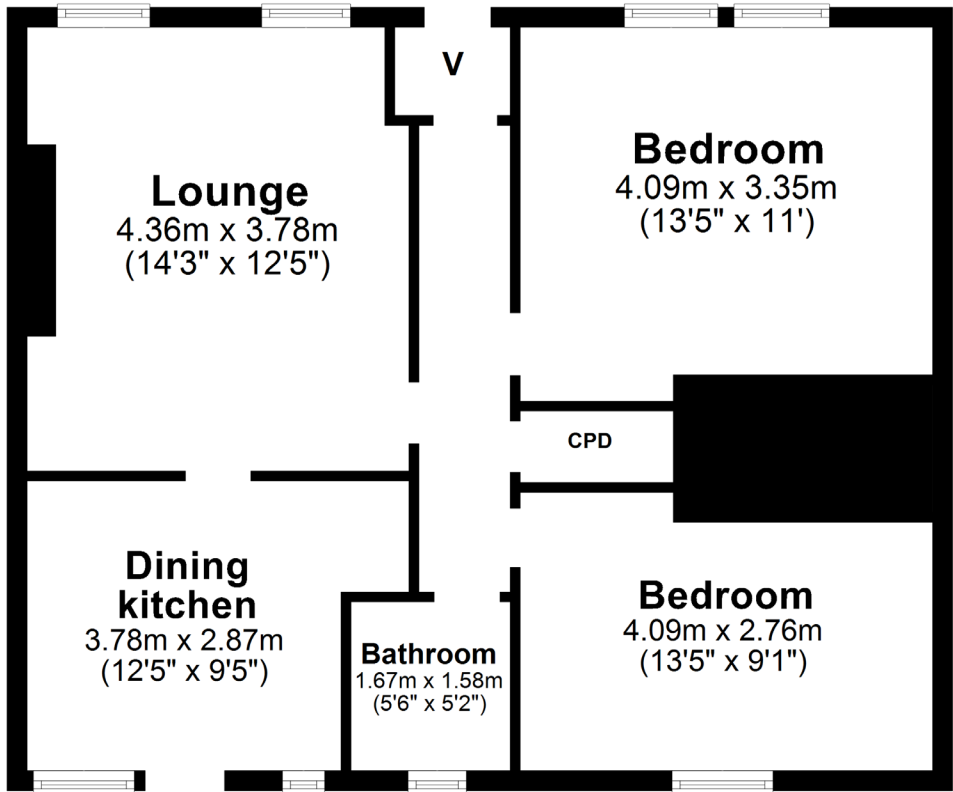

Local Area

Woodfield Crescent is a popular and quiet residential locale close to a wide range of amenities. Both Ayr and Prestwick town centres are within close proximity and provide a more comprehensive range of amenities including supermarket and retail shopping, transport and recreational facilities. For the commuter there are excellent road and rail links to Glasgow and surrounding areas.

AY3883 | Sat Nav: 13 Woodfield Crescent, Ayr, KA8 8NU

* All measurements and distances are approximate Floorplans are for illustration purposes and may not be to scale.



WE'RE **SOLD** ON YOUR FUTURE

Corum Ayr

14 Beresford Terrace, Ayr KA7 2EG

Tel: 01292 880 888 **Fax:** 01292 880 888 **Email:** ayr@corumproperty.co.uk

www.corumproperty.co.uk