





■ ■ ■  
c o r u m



# CATTERMUIR GATEHOUSE, CROFTAMIE

1 | BEDROOM   1 | BATHROOM   1 | PUBLIC ROOM

**Set in a wonderfully mature garden, in the heart of rural Stirlingshire, and within The Trossachs and Loch Lomond National Park, this most charming, red sandstone, former gatehouse offers an exciting development opportunity.**

There is excellent scope to extend the property into a larger home, subject to the necessary planning permissions.

These traditional but and ben style properties make popular holiday homes and staycation/Airbnb rentals.

The corner plot is afforded great privacy by a mature hedge, trees and shrubs.

The accommodation on offer extends to:

- Large entrance porch
- Reception hallway
- Open plan lounge/kitchen, with fireplace and dual aspect windows
- Double size bedroom
- Recently replaced shower room
- Electric heating
- Off-street driveway parking

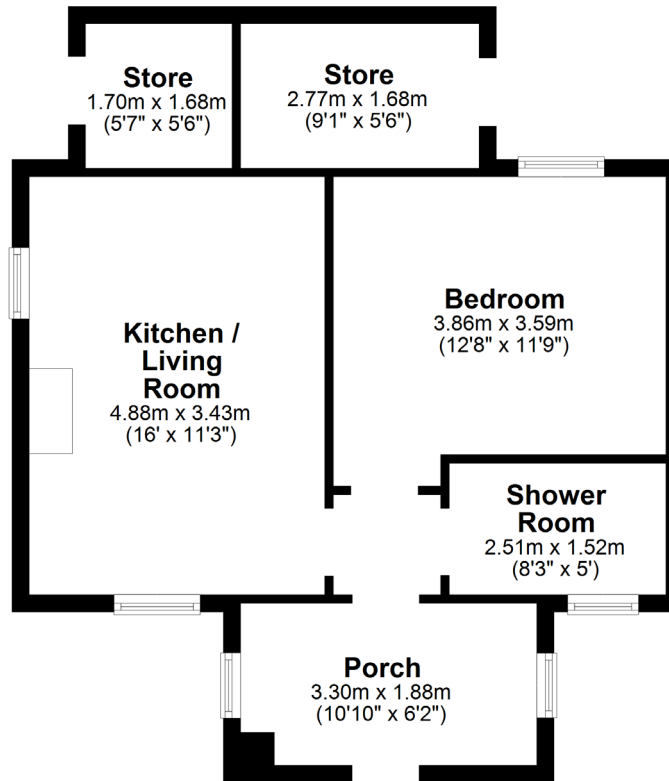

**BD3315 | Sat Nav:** Cattermuir Gatehouse, Croftamie, G63 0HG

All measurements and distances are approximate. Floorplans are for illustration purposes and may not be to scale.



corum





## **LOCAL AREA & AMENITIES**

Croftamie is a picturesque Stirlingshire village, neighbouring the popular villages of Gartocharn and Drymen, where a number of local shops and facilities can be found, including convenience stores, post office, doctors, dentists, village halls and sporting pursuits. Croftamie village falls within the catchment area for the popular Drymen Primary School and the sought after Balfron High School. Loch Lomond is only a short drive, where a wealth of outdoor and on water pursuits can be enjoyed. The nearest railway stations can be found at Balloch and Milngavie. The village is approximately 35 mins from Glasgow City Centre and Glasgow Airport. In the other direction, Stirling is approximately 30 minutes away with the main motorway network easily accessible.

For The Full Home Report Visit:

**[WWW.CORUMPROPERTY.CO.UK](http://WWW.CORUMPROPERTY.CO.UK)**



c o r u m

WE'RE **SOLD** ON YOUR FUTURE

4 Canniesburn Toll, Bearsden G61 2QU

Tel: 0141 942 5888 - Email: [bearsden@corumproperty.co.uk](mailto:bearsden@corumproperty.co.uk) - Fax: 0141 943 2288