



THE PROPERTY

3 | BEDROOMS 1 | BATHROOM
2 | PUBLIC ROOMS

Positioned in private garden grounds and delivering some lovely period features, this mid terrace property originally dates from the early 1900s. On the doorstep of a celebrated community, this home is well proportioned and nearby the popular Queens Park with its redeveloped bandstand.

- Stone built mid terrace home
- Bay windowed living room
- Three bedrooms
- Kitchen next to dining room
- Beautiful stained glass
- Thriving local amenities

Amenities

20 Braemar Street is within half a mile of excellent amenities including the coffee houses, gastropubs and bakeries of Battlefield and Langside. More extensive facilities are available at the Crossmyloof Morrisons store or the Sainsburys store on Battlefield Road. Queens Park is also within half a mile of the front door providing green space, farmers markets, football, tennis and basketball facilities. The nearest railway stations are Mount Florida or Langside and bus routes are aplenty on nearby Sinclair Drive.



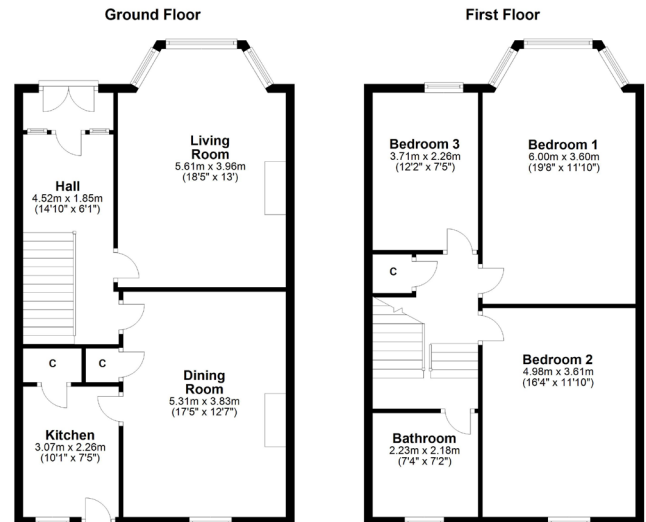

SS3945 | Sat Nav: 20 Braemar Street, Battlefield, Glasgow, G42 9QA

All measurements and distances are approximate.
Floorplans are for illustration purposes and may not be to scale.

For the full home report visit www.corumproperty.co.uk



■ ■ ■
c o r u m

WE'RE **SOLD** ON YOUR FUTURE

247 Kilmarnock Road Shawlands G41 3JF

Tel: 0141 636 7588 - Email: shawlands@corumproperty.co.uk - Fax: 0141 636 7589