



THE PROPERTY

2 | BEDROOMS 1 | BATHROOM
1 | PUBLIC ROOM

Positioned at garden level in a sandstone townhouse, this charming conversion is found in the Strathbungo conservation district. The building was split some years ago to house three dwellings all of which have access into a sleek entrance hallway and main door access thereafter.

- Garden level townhouse conversion
- Wonderful living dining room
- Two double sized bedrooms
- Refurbished shower room
- Private South West facing garden
- Off street parking via rear lane

Amenities

38 Marywood Square is in the thriving Southside community of Strathbungo where independent restaurants, shops, bars and coffee houses are all within walking distance. Queens Park is approximately 250 yards away providing recreational space, tennis courts, football pitches and farmers markets. Pollokshields West and Queens Park train stations are within half a mile of the front door.



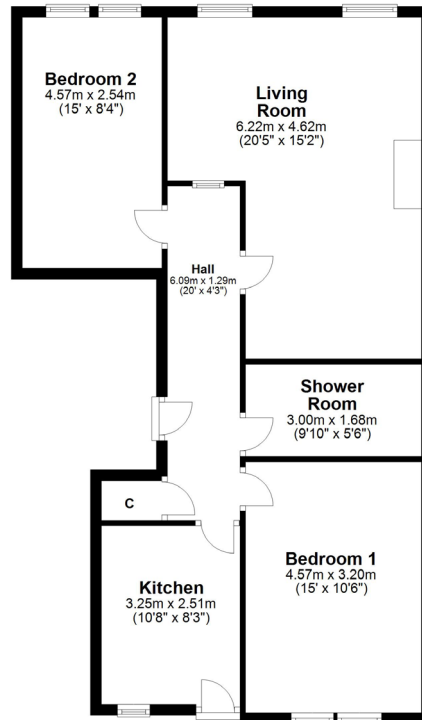

SS3950 | Sat Nav: 38 Marywood Square, Strathbungo, G41 2BJ

All measurements and distances are approximate.
Floorplans are for illustration purposes and may not be to scale.

For the full home report visit www.corumproperty.co.uk



corum

WE'RE **SOLD** ON YOUR FUTURE

247 Kilmarnock Road Shawlands G41 3JF

Tel: 0141 636 7588 - Email: shawlands@corumproperty.co.uk - Fax: 0141 636 7589