



THE PROPERTY

4 | BEDROOMS 2 | BATHROOMS
2 | PUBLIC ROOMS

This substantial, six apartment top floor tenement flat is superb. It is situated within a handsome blonde sandstone A listed tenement designed by the highly renowned Charles Wilson circa 1860. The duplex apartment occupies the third and attic level and extends to well over 2000 square feet, providing flexible well-proportioned accommodation.

A secure entry system provides access to a well maintained residents communal hall and the accommodation comprises; welcoming reception hall, stunning, recently fitted dining kitchen, breath-taking bay windowed lounge with feature fireplace and semi open plan dining/study room that can be closed off with double sliding doors, the views here are spectacular over the City. Completing the lower floor accommodation is a well-proportioned shower room and a versatile room that could be used as a fourth bedroom/home office.

Upstairs, is the principal bedroom with en-suite shower room, two further bedrooms and a family bathroom.

Th property benefits from gas central heating, ample on street parking and residents can apply for an on street Permit via Glasgow City Council. There is also a residents communal garden to the rear of the building.



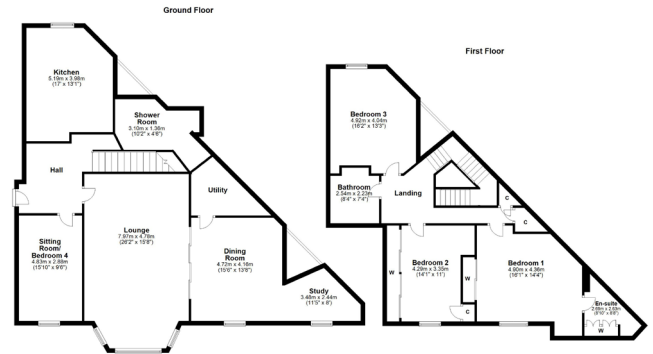

WE4415 | Sat Nav: 2 Park Quadrant, Park, G3 6BS

All measurements and distances are approximate.
Floorplans are for illustration purposes and may not be to scale.

For the full home report visit www.corumproperty.co.uk



■ ■ ■
c o r u m

WE'RE **SOLD** ON YOUR FUTURE

82 Hyndland Road, G12 9UT

Tel: 0141 357 1888 - Email: westendnq@corumproperty.co.uk - Fax: 0141 357 1188