



THE PROPERTY

1 | BEDROOM 1 | BATHROOM

1 | PUBLIC ROOM

A luxury first floor retirement flat located in the heart of Giffnock village.

- Beautiful first floor apartment with a lovely south facing aspect
- 24-hour on-site management
- In-house restaurant, residents' lounge, and conservatory
- Guest suite and laundry room
- Private residents' parking and within walking distance of all amenities
- Lovely, landscaped gardens with private residents' patio

Amenities

Recently voted one of the top 100 places to live within the UK by the Sunday Times newspaper, Giffnock continues to be one of the most desirable residential suburbs on Glasgow's south side. There are excellent transport links via bus and train (Giffnock Station) providing swift access to the city centre and beyond, and numerous independent retail outlets, shops, restaurants and delicatessens are available within the area.



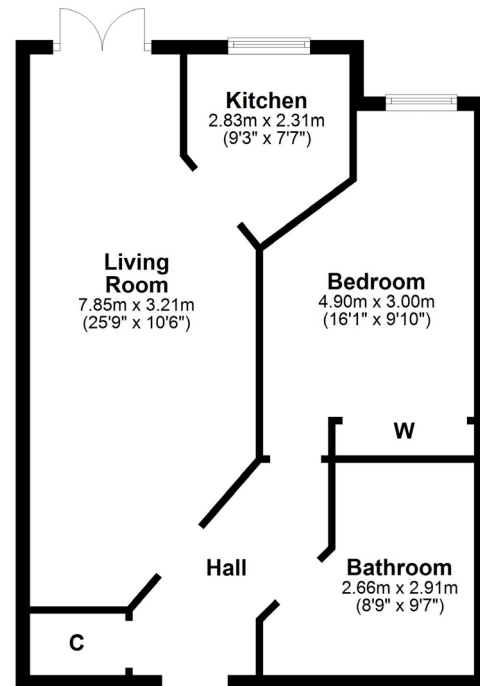

NM3777

Sat Nav: 21 Hilltree Court, 96 Fenwick Road, Giffnock, G46 6AA

All measurements and distances are approximate.
Floorplans are for illustration purposes and may not be to scale.

For the full home report visit www.corumproperty.co.uk



WE'RE **SOLD** ON YOUR FUTURE

134 Ayr Road, Newton Mearns G77 6EG

Tel: 0141 639 5888 - Email: n.mearns@corumproperty.co.uk - Fax: 0141 639 1188