



**25 WOODROW COURT**  
PORT GLASGOW ROAD, KILMACOLM

# THE PROPERTY

1 | BEDROOM    1 | BATHROOM

1 | PUBLIC ROOM

**A beautifully presented and particularly bright, one bedroom retirement flat located in close proximity to local amenities and bus links within Kilmacolm.**

- Freshly decorated, first floor, retirement flat
- Sought after McCarthy & Stone development
- Convenient village location
- Spacious lounge with Juliet style balcony
- Double bedroom with built in wardrobes
- Shower room with WC and wash hand basin
- Double glazing and electric central heating
- Resident's parking and communal lift

## Amenities

Kilmacolm is a highly soughtafter village positioned in the heart of the Gryffe valley. The village offers an excellent range of shops, cafes and restaurants. Local schooling includes Kilmacolm Nursery and Primary School with secondary education at the modern Port Glasgow High School Campus. The village is home to the independent Duchal Nursery School and the prestigious St. Columba's School. The sporting and leisure amenities are varied with a tennis club, bowling club, the picturesque Kilmacolm Golf Club, Birkmyre Park playing fields and gym, local fisheries and angling at Knapps Loch and the River Gryffe.



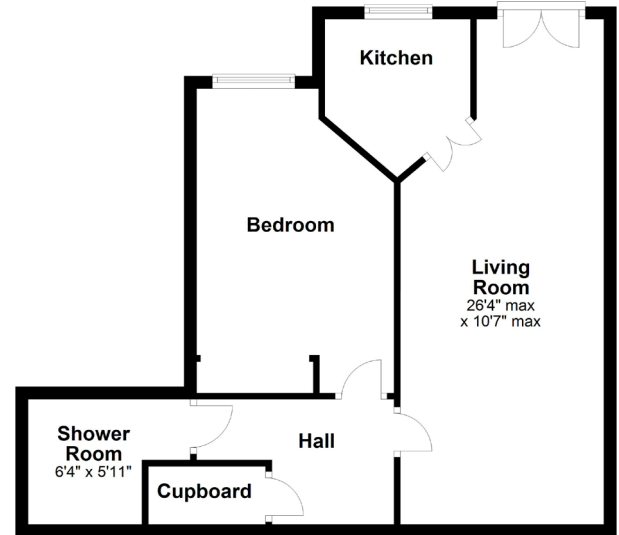

**BW2049** | Sat Nav: 25 Woodrow Court, Port Glasgow Road, Kilmacolm, PA13 4QA

All measurements and distances are approximate.  
Floorplans are for illustration purposes and may not be to scale.

For the full home report visit [www.corumproperty.co.uk](http://www.corumproperty.co.uk)



■ ■ ■  
c o r u m

WE'RE **SOLD** ON YOUR FUTURE

2 Windsor Place, Main Street, Bridge of Weir PA11 3AF

Tel: 01505 691 400 - Email: [bridgeofweir@corumproperty.co.uk](mailto:bridgeofweir@corumproperty.co.uk)