



3 / 3 22 CLOUSTON STREETDENS

NORTH KELVINSIDE

THE PROPERTY

2 | BEDROOMS 2 | BATHROOMS
1 | PUBLIC ROOM

A superb, top floor, two bedroom tenement flat with enviable views.

This wonderful top floor tenement flat in the heart of North Kelvinside is in superb condition throughout and has some fantastic views over the West End and beyond. The flat is situated close to the North Kelvin Meadow, which is a fantastic green space for the whole community to enjoy. Byres Road, and all the amenities it has to offer, is also within close proximity.

The building is initially accessed via a secure entry system into a well-kept residents' communal close that in turn, provides access to the immaculate rear courtyard. The internal accommodation comprises: welcoming reception hall, large bay windowed lounge with ample space for dining, bay windowed bedroom and a large principal bedroom with en-suite shower. There is a well-proportioned kitchen with a range of base and wall mounted units and a family bathroom with three piece suite.

In addition, the property has gas central heating, hardwood flooring, and residents on street permit parking can be requested via Glasgow City Council.



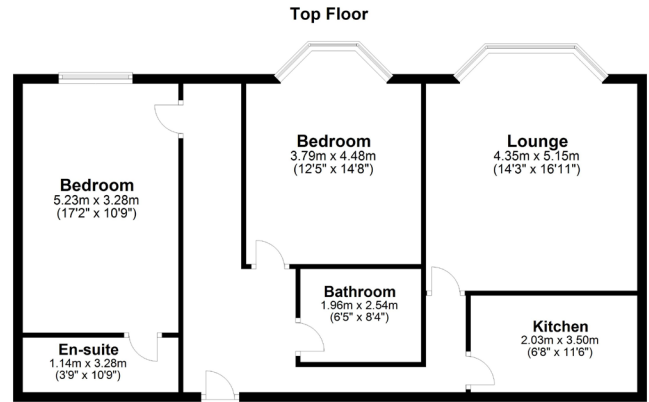

WE4482 | Sat Nav: 3/3 22 Clouston Street, North Kelvinside, Glasgow, G20 8QU

All measurements and distances are approximate.
Floorplans are for illustration purposes and may not be to scale.

For the full home report visit www.corumproperty.co.uk



■ ■ ■
C O R U M

WE'RE **SOLD** ON YOUR FUTURE

82 Hyndland Road, G12 9UT

Tel: 0141 357 1888 - Email: westendnq@corumproperty.co.uk - Fax: 0141 357 1188