



# 6 JOHN CLARK STREET

## LARGS

[www.corumproperty.co.uk](http://www.corumproperty.co.uk)



2 | BEDROOMS  
1 | BATHROOM  
1 | PUBLIC ROOM

Well placed for ease of access to Largs town centre with its wide range of amenities, train and bus terminals and occupying a ground floor location, 6 John Clark Street is a traditionally built quarter villa that will suit clients of all age groups.

The accommodation on offer comprises entrance vestibule which opens to a reception hallway giving access to a front facing lounge with bay window and fireplace at its focal point. The kitchen is fitted with a range of modern wall and base units with integrated appliances to include ceramic hob, oven, microwave and extractor. The kitchen is plumbed for a washing machine. The bathroom has been adapted to form a wet room with three piece to include WC, wash hand basin and shower area with electric shower. The property has two well proportioned double bedrooms both with built in wardrobe storage. In addition to the above the property has double glazing, gas central heating and a private monobloc terrace with two well maintained sheds.

Amenities

Largs is a popular holiday destination and is becoming increasingly popular for those looking for a seaside home in a town with a good range of amenities and recreational facilities. The Largs Academy Campus (built 2018) incorporates Early Years Learning, Largs Primary and St Mary's Primary as well as the highly regarded Largs Academy. Inverclyde, Scotland's National Sport's centre has also recently been refurbished. The area has excellent travel links including Largs railway station, bus routes and easy access to the major road networks. There are many restaurants and hotels in the area, with the yacht marina and seafront being an attraction for many. Prestwick and Glasgow Airport offer regular flights throughout Britain, Ireland and Europe.

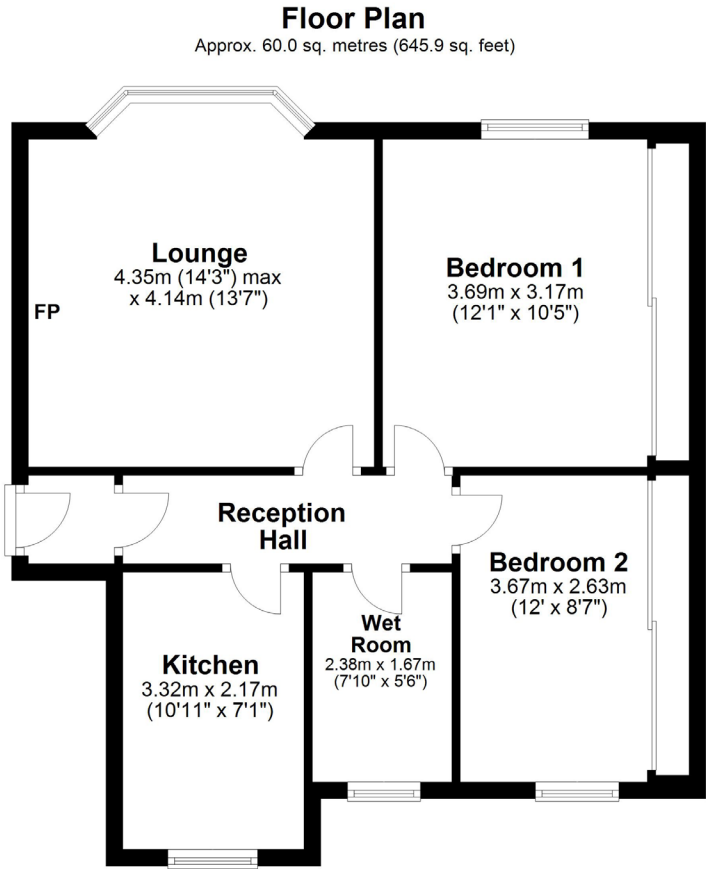

Total area: approx. 60.0 sq. metres (645.9 sq. feet)

Sat Nav:  
6 John Clark Street, Largs, KA30 9AH  
LA1610

\*All measurements and distances are approximate.  
Floorplans are for illustration purposes and may not be to scale.

For the full home report visit  
[www.corumproperty.co.uk](http://www.corumproperty.co.uk)





WE'RE **SOLD** ON  
YOUR FUTURE



Corum Ayr  
14 Beresford Terrace, Ayr, KA7 2EG

**Tel:** 01292 880 888

**Email:** [ayr@corumproperty.co.uk](mailto:ayr@corumproperty.co.uk)

[www.corumproperty.co.uk](http://www.corumproperty.co.uk)