



CARNAMAH

MIMOSA ROAD, BRIDGE OF WEIR

www.corumproperty.co.uk





2 | BEDROOMS

2 | BATHROOMS

1 | PUBLIC ROOM

A truly stunning two bedroom detached bungalow finished to a high spec throughout commanding a large level plot in Bridge of Weir.

Occupying a large level plot within the sought after 'Gryffe High School' catchment area of Bridge of Weir is this truly stunning and quite unique detached bungalow. 'Carnamah', is a contemporary styled family home offering spacious living on over one level and finished with quality fixtures, fittings and stylish décor throughout creating a highly attractive home for a wide range of prospective buyers. The specification of the property includes gas fired central heating and double glazing throughout.

The internal accommodation comprises of an entrance hallway which provides access to all of the rooms and features two large storage cupboards. The impressive open plan lounge/kitchen area is bathed in natural light from front and rear positioned windows. There is ample space for living room furniture and a host of fitted units with integral appliances as well as a central island with a breakfasting bar. Positioned off the kitchen is the utility room which has further storage units, a door to the rear garden and space for two free standing appliances. Both bedrooms are generously sized double rooms, one of which has a bay window formation. The other bedroom benefits from a fully tiled en-suite shower room. There is a stunning family bathroom which comprises of a three piece suite with mains shower over the bath with stylish tiling.

There is a large 'L' shaped Monoblock driveway providing ample off street parking. The rear garden is fully enclosed and nicely screened by mature trees and is made up of a central lawn and patio area. At the rear of the garden is a large outbuilding spanning over 33ft in length and has double glazed window units and electricity.



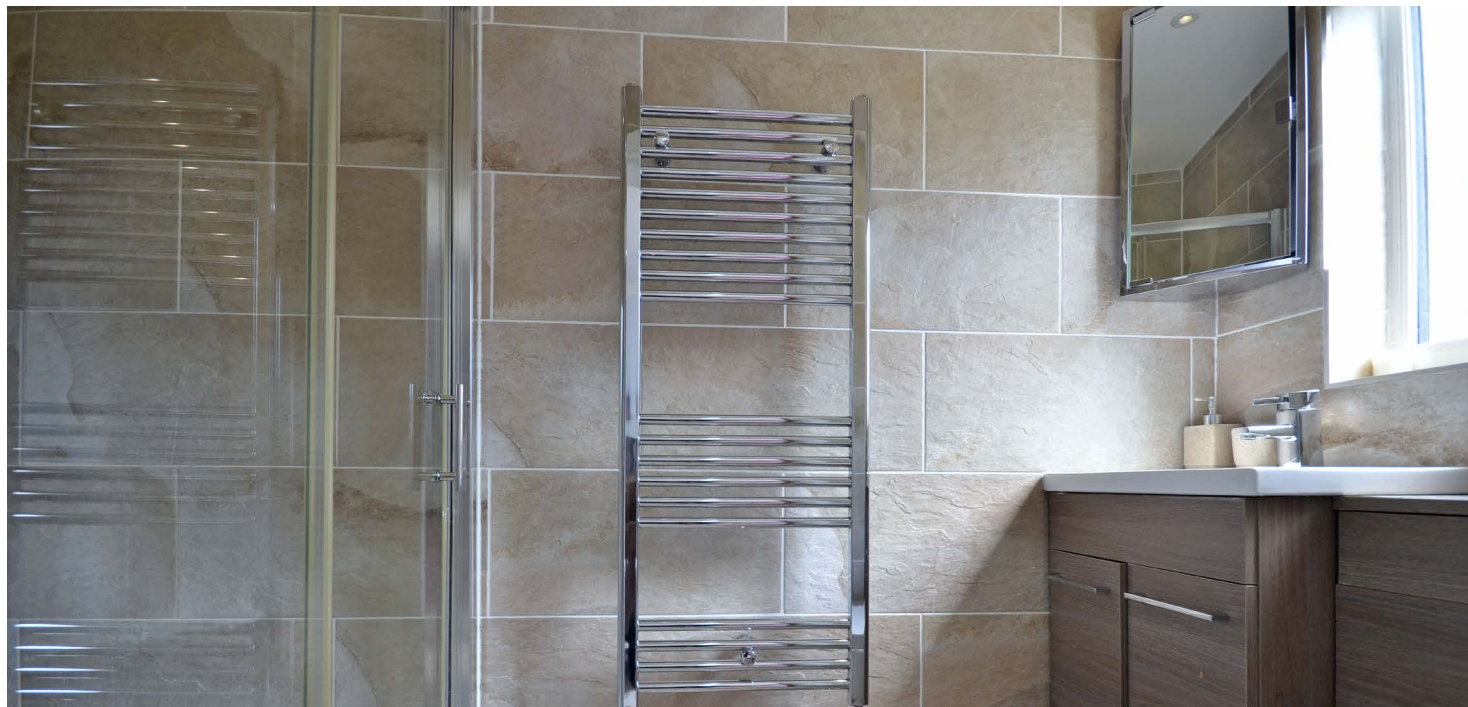

Ground Floor

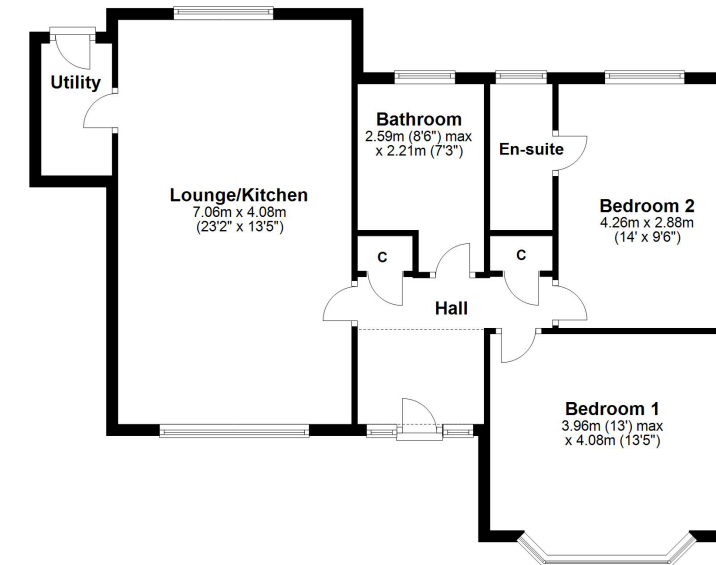
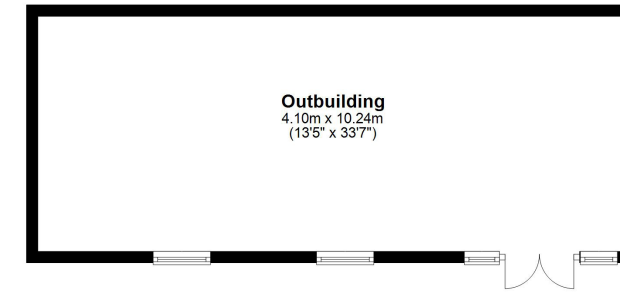

Bridge of Weir has good road links towards the M8 motorway, Glasgow International Airport and Glasgow city centre. The village offers a wide range of local amenities including restaurants, shops and a library. The village has a popular Primary School with a nursery and secondary education is at the prestigious Gryffe High School. There is also private schooling nearby at St. Columba's in Kilmacolm. The village has two 18 hole golf courses and there is fishing available on the River Gryffe.

BW2076 | Sat Nav: Carnamah, Mimosa Road, Bridge of Weir, PA11 3NF

For the full home report visit www.corumproperty.co.uk

* All measurements and distances are approximate Floorplans are for illustration purposes and may not be to scale.



WE'RE **SOLD** ON
YOUR FUTURE



Corum Bridge Of Weir
2 Windsor Place, Main Street, Bridge Of Weir, PA11 3AF

Tel: 01505 691 400

Email: bridgeofweir@corumproperty.co.uk

www.corumproperty.co.uk