



127 ELLON WAY

PAISLEY

www.corumproperty.co.uk



1 | BEDROOM
1 | BATHROOM
1 | PUBLIC ROOM

A stunning modern one bedroom apartment, substantially upgraded to provide contemporary stylish accommodation with remodeled interior in this popular Cala homes development.

- Ground floor apartment in Cala development
- Landscaped communal gardens with designated parking areas
- Residential location yet convenient for access to Paisley town centre and the M8 motorway network
- Reconfigured semi open plan layout with reception hallway leading into stunning lounge open to refitted kitchen
- Double bedroom with mirror fronted wardrobes
- Upgraded wet room with contemporary sanitary wear
- Double glazing, wet electric heating system security access system

Amenities

The historic town of Paisley has an excellent range of shopping, sporting facilities, transport links and the impressive Paisley Abbey. Regular mainline railway services to Glasgow City centre and the Clyde coast. Connections to Glasgow International Airport and the M8 motorway. Paisley is home to the University of The West of Scotland and has established schooling in the local area. Gleniffer Braes has a variety of walks, Paisley Golf Club and stunning views toward the Campsie Hills.

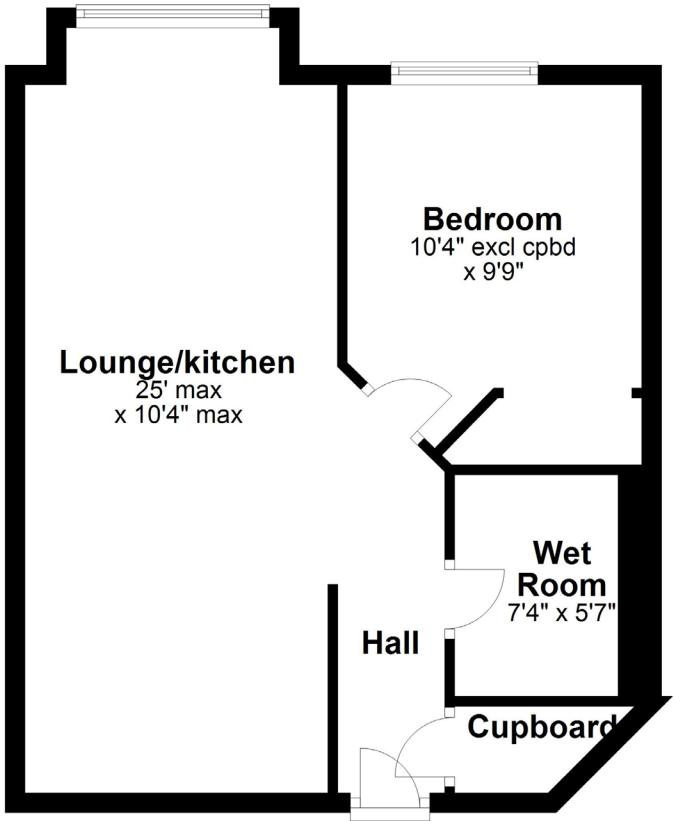

Sat Nav:
127 Ellon Way, Paisley, PA3 4BQ

BW2072

*All measurements and distances are approximate.
Floorplans are for illustration purposes and may not be to scale.

For the full home report visit
www.corumproperty.co.uk



WE'RE **SOLD** ON
YOUR FUTURE



Corum Bridge Of Weir
2 Windsor Place, Main Street, Bridge Of Weir, PA11 3AF

Tel: 01505 691 400

Email: bridgeofweir@corumproperty.co.uk

www.corumproperty.co.uk