



8 BOYDSTONE PATH

GLASGOW

www.corumproperty.co.uk



2 | BEDROOMS
1 | BATHROOM
1 | PUBLIC ROOM

A beautiful mid-terrace villa situated in a highly convenient and popular location.

- Two double bedrooms
- Breakfasting kitchen
- WC
- Astro – turf rear garden
- Extensive storage space
- Allocated parking

Amenities

Boydstone Path is ideally placed for a vast array of local amenities, include numerous parks, golf courses, shops and restaurants. High street shopping can also be found a short distance away at Silverburn and Braehead shopping centres. Public transport links can be found on Barrhead Road, as well as easy access to the motorway network for access to Glasgow City Centre and destinations further afield.



Ground Floor
Approx. 27.2 sq. metres (293.1 sq. feet)

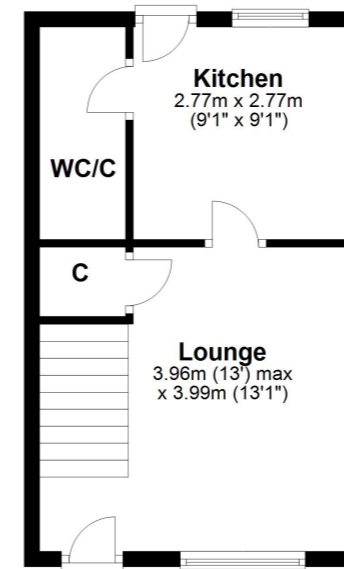

First Floor
Approx. 32.6 sq. metres (351.2 sq. feet)

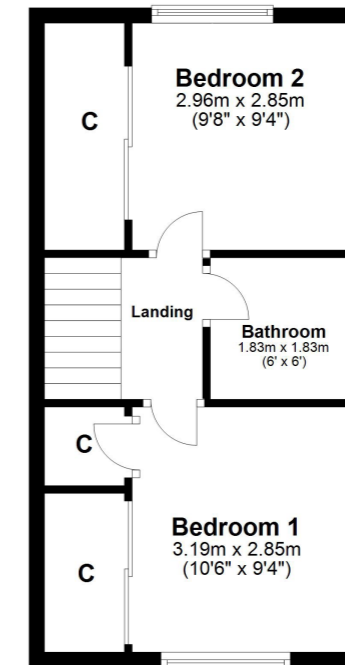

Sat Nav:
8 Boydstone Path, Glasgow, G43 1AJ

SS4137

*All measurements and distances are approximate.
Floorplans are for illustration purposes and may not be to scale.

For the full home report visit
www.corumproperty.co.uk



WE'RE **SOLD** ON
YOUR FUTURE



Corum Shawlands
247 Kilmarnock Road, Shawlands, G41 3JF

Tel: 0141 636 7588

Email: shawlands@corumproperty.co.uk

www.corumproperty.co.uk