



1/1, 8 MELVILLE STREET

POLLOKSHIELDS

www.corumproperty.co.uk

c o r u m

2 | BEDROOMS

1 | BATHROOM

1 | PUBLIC ROOM

A first floor traditional tenement flat enjoying a highly convenient and popular Pollokshields address.

- Two double bedrooms
- Dining kitchen
- Large bay windowed lounge
- Extensive storage space
- Communal resident's gardens
- Secure entrance system

Amenities

8 Melville Street is close to numerous amenities within Pollokshields and Strathbungo, including shops, restaurants, bars and coffee houses. Excellent schooling is available nearby whilst public transport is close to hand at Pollokshields West train station and Shields Road underground station with its 'park and ride' facility. Queen's Park, Maxwell Park and Pollok Park provide recreational space and are all within one mile of the front door.

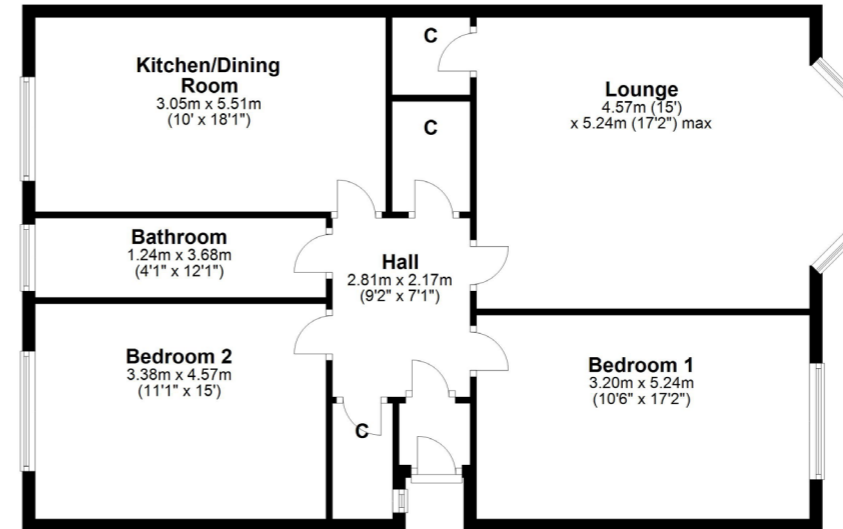

Sat Nav:
8 Melville Street, Pollokshields, G41 2LN

SS4138

*All measurements and distances are approximate.
Floorplans are for illustration purposes and may not be to scale.

For the full home report visit
www.corumproperty.co.uk



WE'RE **SOLD** ON
YOUR FUTURE



Corum Shawlands
247 Kilmarnock Road, Shawlands, G41 3JF

Tel: 0141 636 7588

Email: shawlands@corumproperty.co.uk

www.corumproperty.co.uk