



WOODEND COTTAGE

KENSTEY FARM ROAD, BY MAUCHLINE

www.corumproperty.co.uk





3 | BEDROOMS

1 | BATHROOM

3 | PUBLIC ROOMS

An impressive modern detached bungalow set in an idyllic country location with far reaching views and providing spacious accommodation with generous gardens and double garage.

Woodend Cottage is a rarely available detached country bungalow which enjoys a very private position just over two miles from Mauchline and close to Catrine. Although requiring a degree of modernisation the property provides well proportioned accommodation suited to both families and those clients seeking all on the level living without compromising on space. Features and benefits include a fitted kitchen, double glazing (installed 2022), oil central heating, extensive loft storage and fitted wardrobes in two of the three double bedrooms.

In summary the accommodation extends to, on the ground floor, a broad and welcoming L-shaped reception hallway, lounge with feature fireplace, fitted kitchen open to the dining area, conservatory, useful utility room, three double bedrooms and three piece shower room.

Externally the property is set in good sized gardens predominantly laid to lawn with shrub borders and decorative chipped area. There is driveway parking on both sides of the property. The rear of the property is bordered by beech hedging and has gated entry with a driveway culminating in the detached double garage with purpose built dog runs with internal and external areas.







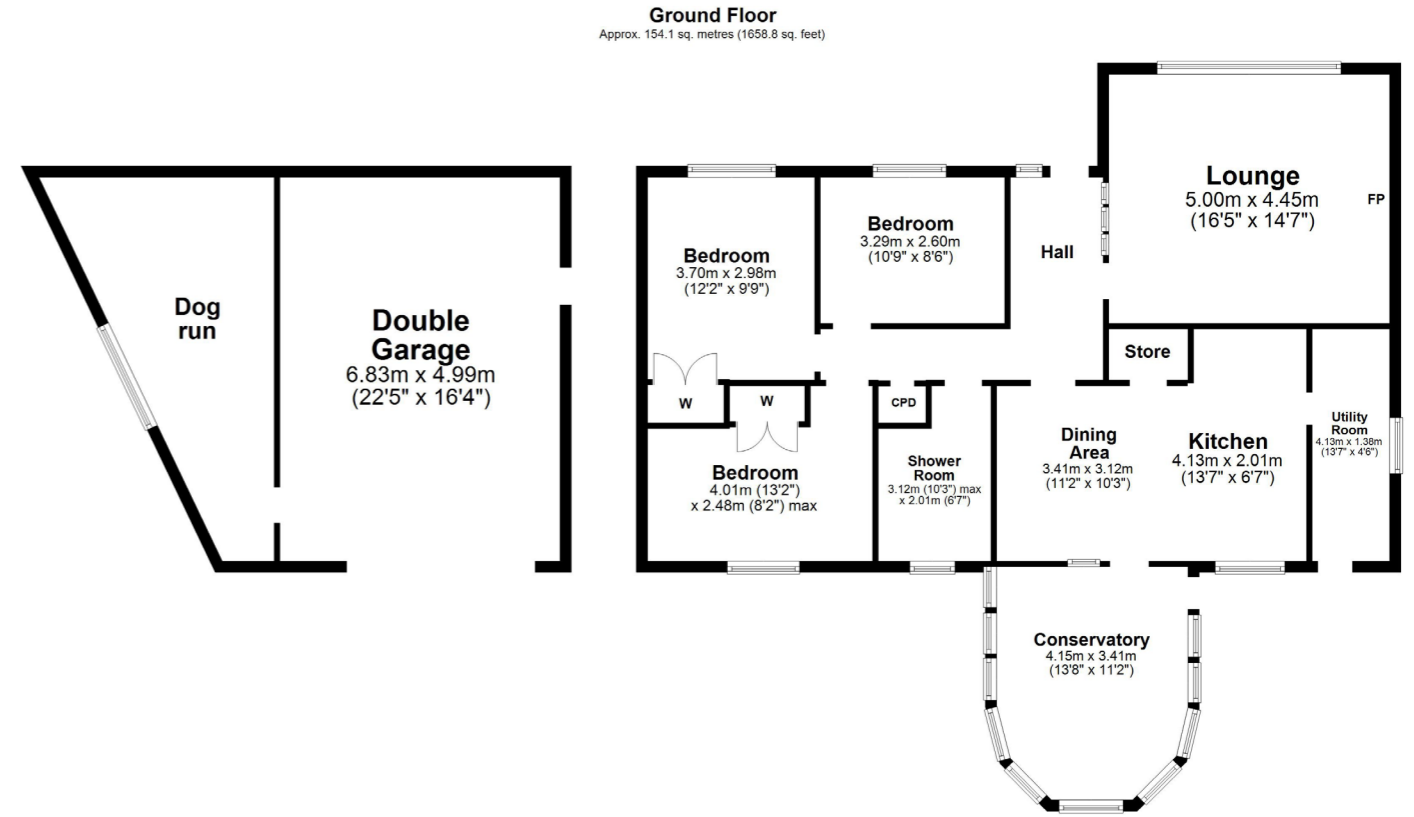

Total area: approx. 154.1 sq. metres (1658.8 sq. feet)

The property is set in generous gardens within an idyllic country setting with open outlook to the front and just over two miles from Mauchline which provides a wide range of amenities including shops and schooling. The location is also within easy reach Kilmarnock and commuting distance of Glasgow via the A76 and M77.

TR1523 | Sat Nav: Woodend Cottage, Kenstey Farm Road, By Mauchline, KA18 2LU

For the full home report visit www.corumproperty.co.uk

* All measurements and distances are approximate Floorplans are for illustration purposes and may not be to scale.



WE'RE **SOLD** ON
YOUR FUTURE



Corum Troon
29 Portland Street, Troon, KA10 6AA

Tel: 01292 310 010
Email: troon@corumproperty.co.uk

www.corumproperty.co.uk