



**63 MAYFIELD CRESCENT**

HOWWOOD

[www.corumproperty.co.uk](http://www.corumproperty.co.uk)



**3 | BEDROOMS**  
**1 | BATHROOM**  
**1 | PUBLIC ROOM**

A chalet style detached villa positioned within an established residential cul de sac in the popular West Renfrewshire village of Howwood.

- Detached chalet style villa
- Entrance porch, reception hallway, lounge open plan to dining room
- Kitchen, bathroom, one downstairs bedroom, rear porch
- Two further double sized upstairs bedrooms
- Gas central heating, double glazing
- Gardens, driveway and garage

**Amenities**

This property is well positioned for all amenities within the village of Howwood including the railway station which allows for travel to North Ayrshire and Glasgow city centre. The A737 (Howwood bypass) links to the M8 motorway at Glasgow International Airport. Schooling is available locally at St Anthony's and Howwood Primary school and St Benedict's and Johnstone High school.

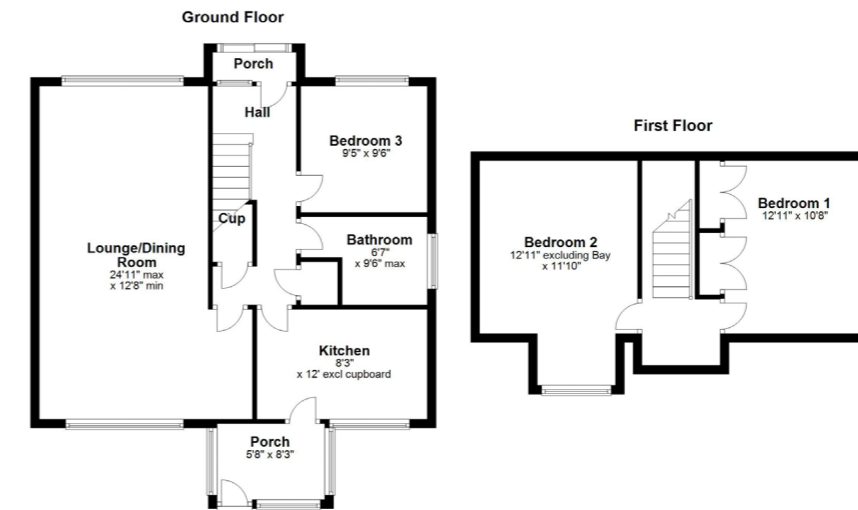

**Sat Nav:**  
 63 Mayfield Crescent, Howwood, PA8 1BL

**BW2095**

\*All measurements and distances are approximate. Floorplans are for illustration purposes and may not be to scale.

For the full home report visit  
[www.corumproperty.co.uk](http://www.corumproperty.co.uk)



WE'RE **SOLD** ON  
YOUR FUTURE



Corum Bridge Of Weir  
2 Windsor Place, Main Street, Bridge Of Weir, PA11 3AF

Tel: 01505 691 400

Email: [bridgeofweir@corumproperty.co.uk](mailto:bridgeofweir@corumproperty.co.uk)

[www.corumproperty.co.uk](http://www.corumproperty.co.uk)