



12 KEIR STREET

POLLOKSHIELDS

www.corumproperty.co.uk

c o r u m

3 | BEDROOMS
1 | BATHROOM
1 | PUBLIC ROOM

A rarely available main door tenement flat, with attractive communal rear gardens and beautifully landscaped private front gardens.

- Large main door flat
- 3 bedrooms (2 large doubles)
- Impressive bay window lounge
- Dining sized kitchen
- Modern bathroom
- Gas central heating, double glazing
- Professionally landscaped front gardens

Amenities

The property is positioned within walking distance of shops and amenities upon Maxwell Road, Albert Drive and Nithsdale Road where thriving coffee shops, restaurants and delicatessens can be found. More extensive amenities are found at the Marks and Spencer's store at Queens Park, the Morrison's store at Crossmyloof or Newlands, or the shopping mall at Silverburn Pollok, a short drive to the South West.

Recreational pursuits in the area are varied including large municipal parks, health clubs/ gyms, golf courses both public and private.

Schooling can be found locally at primary and secondary level.

Frequent public transport provides rapid commuter access to the City Centre

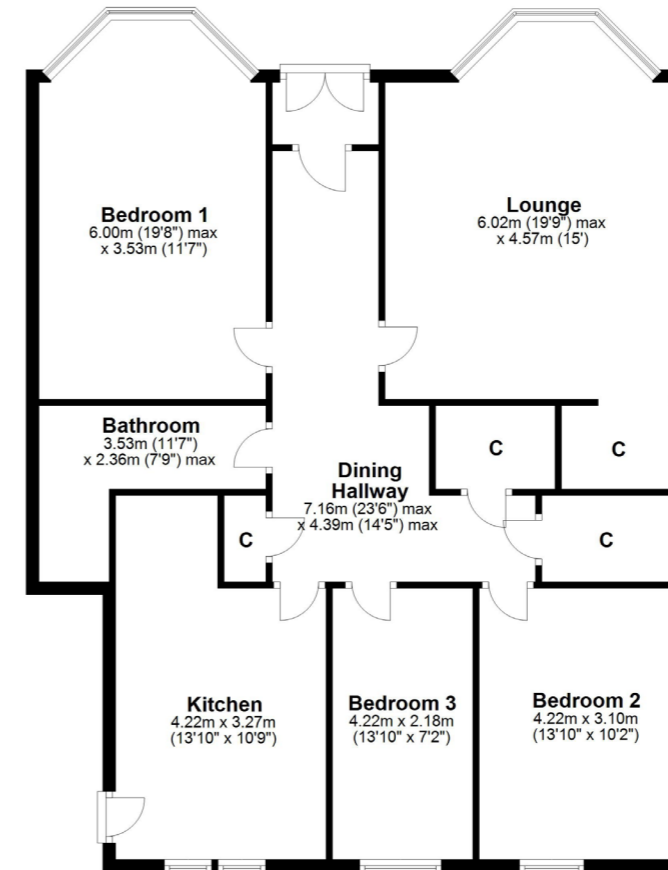

Sat Nav:
 12 Keir Street, Pollokshields, G41 2NW

SS4171

*All measurements and distances are approximate. Floorplans are for illustration purposes and may not be to scale.

For the full home report visit
www.corumproperty.co.uk



WE'RE **SOLD** ON
YOUR FUTURE



Corum Shawlands
247 Kilmarnock Road, Shawlands, G41 3JF

Tel: 0141 636 7588

Email: shawlands@corumproperty.co.uk

www.corumproperty.co.uk