



1/3, 8 MANSIONHOUSE GARDENS

LANGSIDE

www.corumproperty.co.uk



c o r u m

2 | BEDROOMS
1 | BATHROOM
1 | PUBLIC ROOM

A first floor modern flat in a highly popular development within a quiet yet highly convenient setting.

- Two Double Bedrooms
- Dining Kitchen
- Extensive Storage Space
- Electric Heating System
- Residents Car Park
- Secure Entrance System and Communal Gardens

Amenities

Mansionhouse Gardens is a highly regarded development within walking distance of amenities in Langside, Battlefield or Shawlands. Recreational pursuits within the area are namely at Queens Park where nature walks, all weather football pitches, tennis courts and a fortnightly farmers market can be found. The local railway station at Langside is approximately half a mile away.

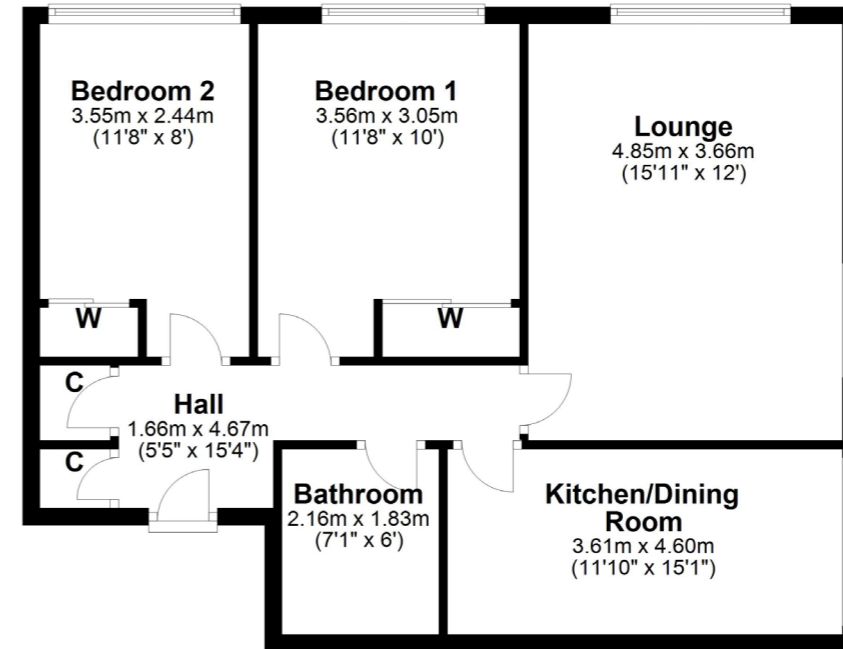

Sat Nav:
8 Mansionhouse Gardens, Langside, G41 3DB

SS4179

*All measurements and distances are approximate.
Floorplans are for illustration purposes and may not be to scale.

For the full home report visit
www.corumproperty.co.uk



WE'RE **SOLD** ON
YOUR FUTURE



Corum Shawlands
247 Kilmarnock Road, Shawlands, G41 3JF

Tel: 0141 636 7588

Email: shawlands@corumproperty.co.uk

www.corumproperty.co.uk