



**3/2 151 BROOMHILL DRIVE**

BROOMHILL

[www.corumproperty.co.uk](http://www.corumproperty.co.uk)



c o r u m





2 | BEDROOMS

1 | BATHROOMS

1 | PUBLIC ROOM

**A beautiful two-bedroom, top floor flat set within a distinctive gothic tenement building in the highly popular and much-admired Broomhill area.**

3/2 151 Broomhill Drive is a beautiful two-bedroom top floor flat, set within a distinctive gothic tenement building in the highly popular and much-admired Broomhill area. Entrance to the building is via an immaculate residents' communal hallway with ornate decorative tiling.

The internal accommodation comprises; large welcoming reception hall with two excellent storage cupboards off and a stunning lounge to the front, with feature gas fireplace and further storage cupboard. To the rear, there is a magnificent, spacious dining/kitchen with a selection of base and wall mounted units. There are two generous sized double bedrooms and finally, a stunning, newly installed family bathroom with over bath shower, completes this accommodation on offer.

The property has gas central heating, secure entry system, access to a shared bike store and well-maintained communal gardens to the rear.







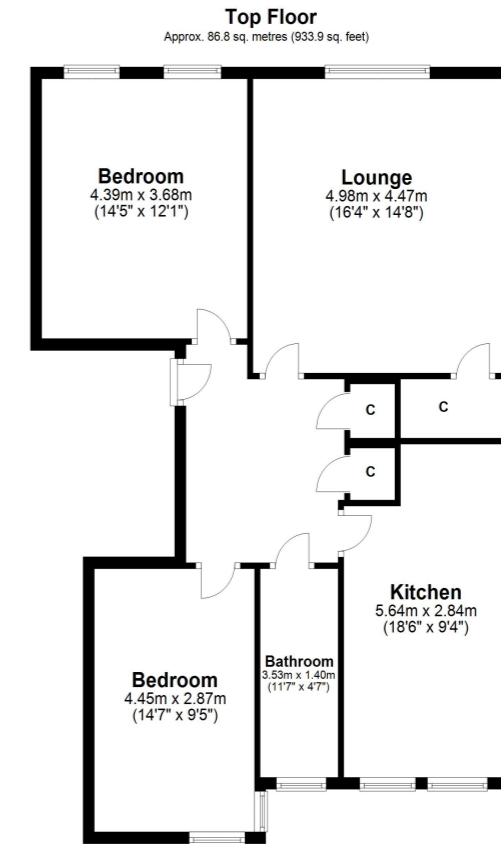

Total area: approx. 86.8 sq. metres (933.9 sq. feet)

Broomhill is a beautiful, leafy district in the West End of Glasgow bounded by the districts of Thornwood and Partick to the south, Hyndland to the east, and Jordanhill, Scotstoun and Victoria Park to the west.

Broomhill Primary School is the main feeder school to the state secondary schools in the area, Hyndland Secondary and St Thomas Aquinas. Broomhill has its own shopping centre located on Broomhill Drive, with shops including a newsagent, a laundrette, Papa John's, a dental surgery, Boots and Co-op convenience store. There are also a large number of shops on Crow Road, including cafés and restaurants, such as Café Circa, Kothel and Oscar & Hollis. There is a retail park on Crow Road where a number of national retailers can be found including Marks & Spencer, Sainsburys, Boots, Superdrug and Argos. A further selection of shops and amenities can be found on Clarence Drive, Hyndland Road and Byres Road.

**WE4610** | Sat Nav: 3/2 151 Broomhill Drive, Broomhill, Glasgow, G11 7ND

For the full home report visit [www.corumproperty.co.uk](http://www.corumproperty.co.uk)

\* All measurements and distances are approximate Floorplans are for illustration purposes and may not be to scale.





WE'RE **SOLD** ON  
YOUR FUTURE



Corum West End  
82 Hyndland Road, Glasgow, G12 9UT

**Tel:** 0141 357 1888

**Email:** [westendenq@corumproperty.co.uk](mailto:westendenq@corumproperty.co.uk)

[www.corumproperty.co.uk](http://www.corumproperty.co.uk)