



THE FAIRWAYS, FLAT 1

823 CLARKSTON ROAD, NETHERLEE

www.corumproperty.co.uk



1 | BEDROOM
1 | BATHROOM
1 | PUBLIC ROOM

Show home condition garden flat within a sought after Netherlee location

- Exclusive Retirement development for the over 60's
- Luxurious garden flat
- Principal bedroom with walk in wardrobe
- Fantastic open plan Lounge / Dining Room
- Modern Fixture and Fittings
- Private garden space
- Safety / Security features
- Complete peace of mind
- Lovely development with House Manager

Amenities

The Fairways is situated within the enviable location in the Netherlee area and close to the local shops and Williamwood Golf Club.

The main shopping area in Clarkston is located a short distance away on Busby Road and is home to a wide variety of shops, cafes, and eateries. Leisure pursuits are well catered for in Clarkston with golf, bowling, and tennis clubs all nearby. Local residents also benefit from a choice of parks in the area including Linn Park and Rouken Glen Park, which offers some lovely walks. Transport links in the area are excellent, with bus stops directly outside the Fairways, and Clarkston railway station, on the main line between Glasgow City Centre and East Kilbride, a short journey away.

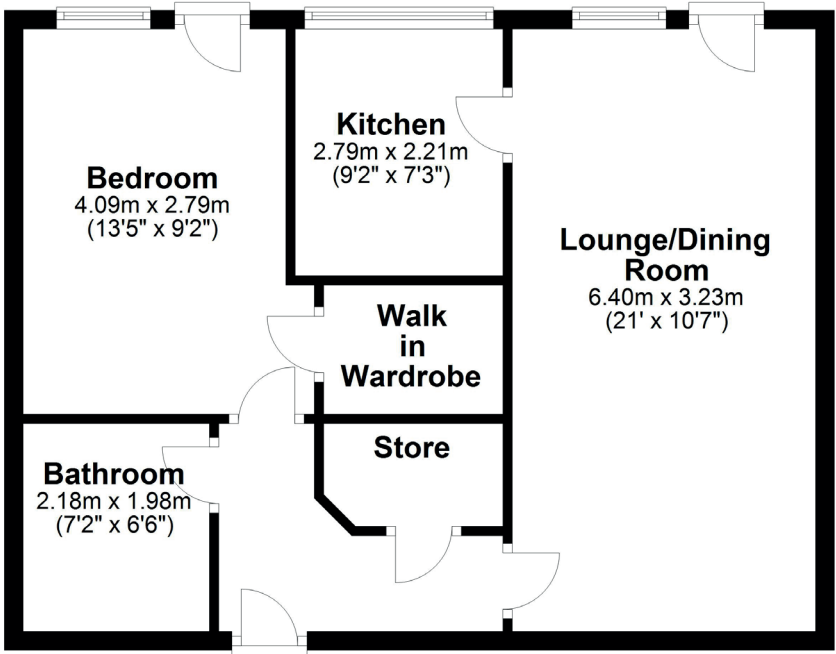

Sat Nav:
823 Clarkston Road, G44 3UZ

CC0612

*All measurements and distances are approximate.
Floorplans are for illustration purposes and may not be to scale.

For the full home report visit
www.corumproperty.co.uk



WE'RE **SOLD** ON
YOUR FUTURE



Corum Clarkston & Netherlee
5 Helena Place, Clarkston, G76 7RB

Tel: 0141 648 6000

Email: clarkston@corumproperty.co.uk

www.corumproperty.co.uk