



2 KIRKDENE GROVE

NEWTON MEARNS

www.corumproperty.co.uk





3/4 | BEDROOMS

2 | BATHROOMS

2/3 | PUBLIC ROOMS

A Mactaggart & Mickel detached villa, set within a private cul-de-sac within walking distance to Kirkhill Primary School and Mearns Castle High School.

This traditional designed detached villa by Mactaggart & Mickel occupies a lovely quiet, secluded setting within this private cul-de-sac and enjoys great proximity to local schooling and amenities. The house provides flexible and versatile spacious family accommodation formed over a two storey layout.

Traditional style reception hallway with study area, downstairs WC, great sized family lounge with French doors through to dining room, downstairs bedroom which is currently used a sitting room with French double glazed doors to gardens and the ground floor is completed by a lovely sized dining kitchen with further access to gardens. Spacious upper landing area gives access to an external sun terrace and provides access to three further bedrooms and main family bathroom. The specification of the house includes an upgraded gas central heating boiler, double glazed windows and the house is presented in excellent decorative order throughout.

The property is set within level garden grounds with gated driveway to the rear offering parking for multiple vehicles leading to single garage (20'0" x 9'3") with up and over door. Fitted with power and light. Lawned garden to rear with patio and expansive lawned garden to the front.



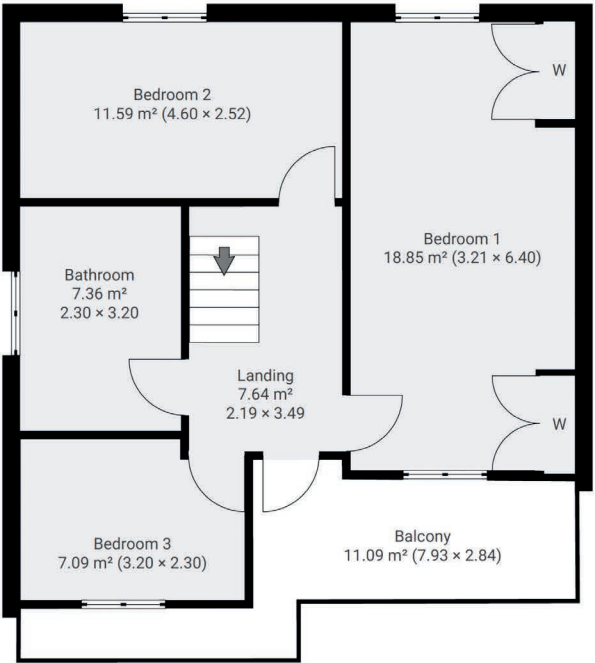
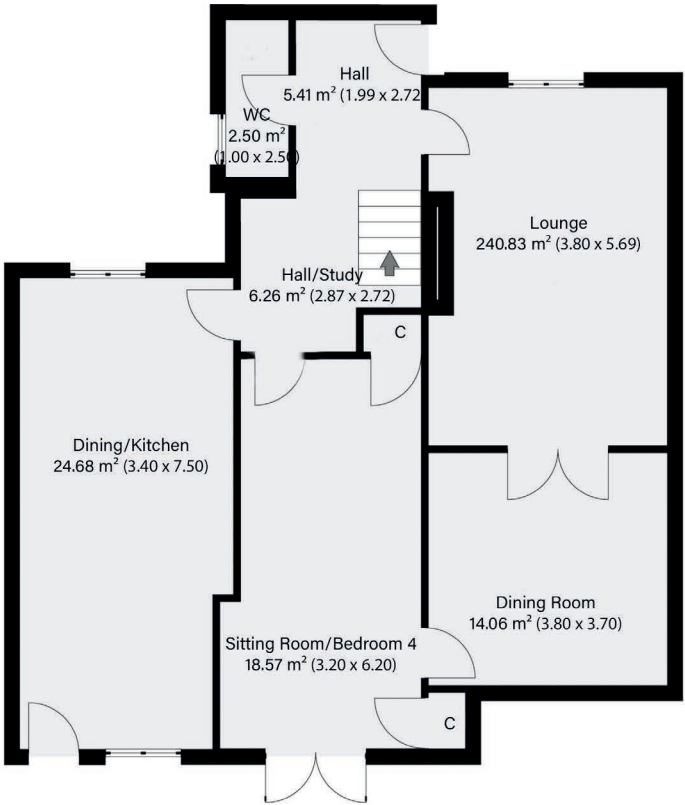

Newton Mearns is one of the most sought after suburbs within the south side of Glasgow. The property is superbly placed for a wide range of amenities and indeed nationally recognised schooling. The property is a short distance away from excellent shopping at The Avenue at Mearns Cross and Greenlaw Village. There are an abundance of sports and recreational facilities found within the district which include excellent golf courses, parks, tennis clubs and there are a variety of country pursuits found nearby at Hazeldene. Local train stations include Whitecraigs Station and Patterton Station.

NM4124 | Sat Nav: 2 Kirkdene Grove, Newton Mearns, G77 5RW

For the full home report visit www.corumproperty.co.uk

* All measurements and distances are approximate Floorplans are for illustration purposes and may not be to scale.



WE'RE **SOLD** ON
YOUR FUTURE



Corum Newton Mearns
134 Ayr Road, Newton Mearns, G77 6EG

Tel: 0141 639 5888

Email: n.mearns@corumproperty.co.uk

www.corumproperty.co.uk