



28 ROLAND CRESCENT

NEWTON MEARNS

www.corumproperty.co.uk





4/5 | BEDROOMS

2 | BATHROOMS

2/3 | PUBLIC ROOMS

A substantial detached family home boasting a coveted Newton Mearns address.

This wonderful, detached villa enjoys a highly sought-after location within this exclusive pocket on Newton Mearns. Enjoying a broad frontage and set within mature garden grounds, the subjects offer a fantastic opportunity to the local marketplace.

Ground floor accommodation extends to bright and welcoming traditional reception hallway with WC and under stair storage off, fantastic dual aspect formal lounge with focal point fireplace, bay window and garden access to the rear, wonderful bay windowed formal dining room, extended modern kitchen with a range of wall and base mounted units and family room adjacent. Upstairs a bright and spacious landing area gives access to generous master bedroom with contemporary en-suite shower room, spacious second double bedroom with lovely aspects over mature front gardens, third double bedroom, good fourth bedroom, main family bathroom and flexible office or fifth excellent bedroom. The specification of the property includes a system of gas central heating, double glazing and the subjects are presented in neutral decorative tones.

Externally the property is set within mature, established garden grounds which are easily maintained by virtue of lawn, decked and paved areas. The property has a detached double garage with parking bays which can be found at the rear of the home.



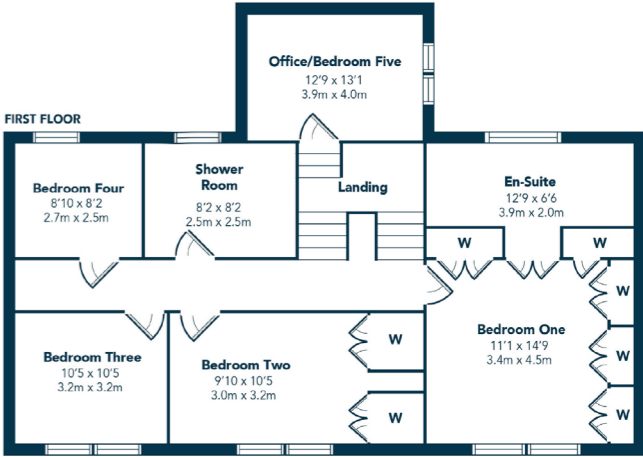
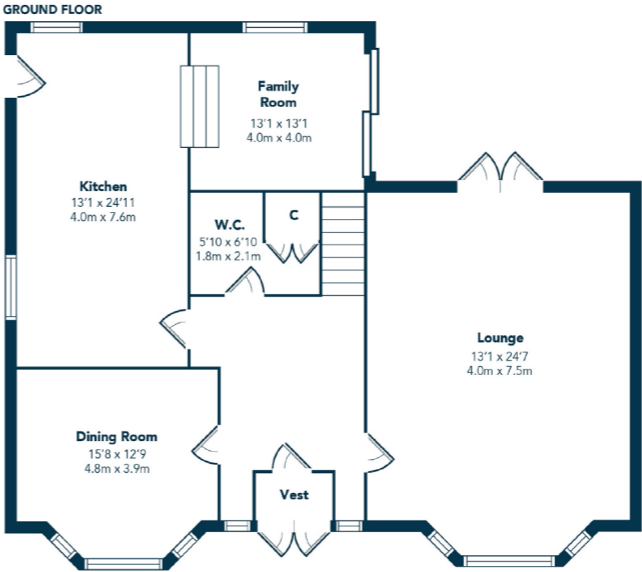

Newton Mearns is one of the most sought-after suburbs within the south side of Glasgow. The property is superbly placed for a wide range of amenities and indeed nationally recognised schooling. The property is a short distance away from excellent shopping at The Avenue at Mearns Cross and Greenlaw Village. There are an abundance of sports and recreational facilities found within the district which include excellent golf courses, parks, tennis clubs and there are a variety of country pursuits found nearby at Hazeldene. Local train stations include Whitecraigs Station and Patterton Station..

NM4159 | Sat Nav: 28 Roland Crescent, Newton Mearns, G77 5JT

For the full home report visit www.corumproperty.co.uk

* All measurements and distances are approximate Floorplans are for illustration purposes and may not be to scale.



WE'RE **SOLD** ON
YOUR FUTURE



Corum Newton Mearns
134 Ayr Road, Newton Mearns, G77 6EG

Tel: 0141 639 5888

Email: n.mearns@corumproperty.co.uk

www.corumproperty.co.uk