



1/1, 128 QUEEN'S DRIVE

QUEEN'S PARK

www.corumproperty.co.uk



3 | BEDROOMS
1 | BATHROOMS
1 | PUBLIC ROOMS

A substantial and well laid out first floor townflat directly opposite Queen’s Park.

- Large first floor flat
- Three double bedrooms (main bedroom is huge)
- Impressive lounge with views over the park
- Modern kitchen with dining nook
- Reconfigured bathroom with sauna and roll top bath
- Communal garden grounds to the rear
- Opposite Queen’s Park

Amenities

128 Queen's Drive strikes the perfect balance of peaceful green space whilst just a brief walk from the thriving community of Strathbungo where a diverse range of independent coffee houses, restaurants and bars are located. Further amenities can be found towards Pollokshields on Kildrostan Street and Nithsdale Road where popular eateries and shops are in abundance.

Queens Park is literally on your doorstep, delivering nature walks, football pitches and tennis courts. Pollokshields West and Queen’s Park train stations are both a short walk of the front door.

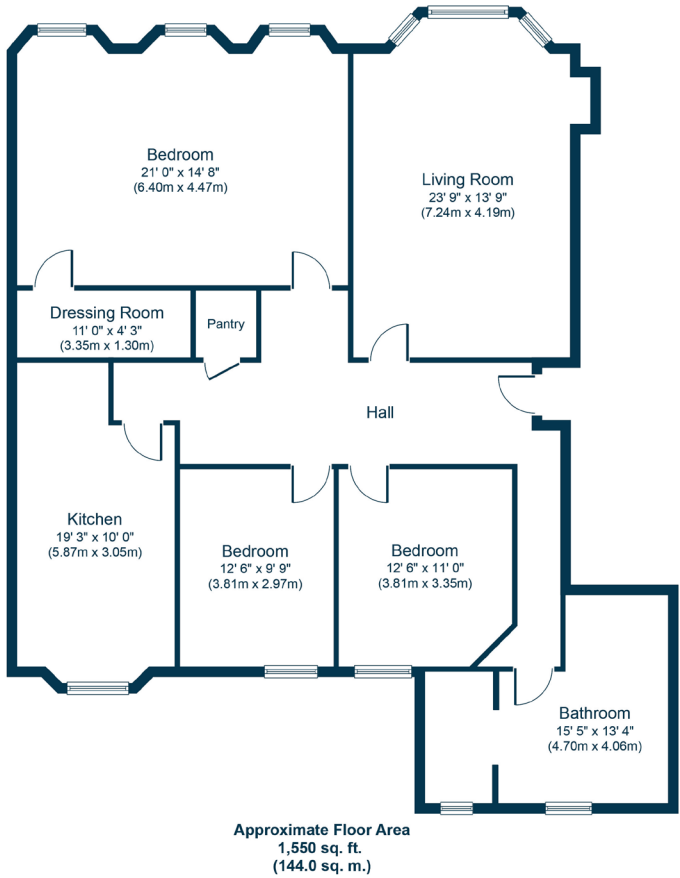

Sat Nav:
1/1, 128 Queen's Drive, Queen's Park, G42 8QN

SS4487

*All measurements and distances are approximate.
Floorplans are for illustration purposes and may not be to scale.

For the full home report visit
www.corumproperty.co.uk



WE'RE **SOLD** ON
YOUR FUTURE



Corum Shawlands
247 Kilmarnock Road, Shawlands, G41 3JF

Tel: 0141 636 7588

Email: shawlands@corumproperty.co.uk

www.corumproperty.co.uk