



22 HEATHFIELD ROAD

AYR

www.corumproperty.co.uk

c o r u m



2 | BEDROOMS

1 | BATHROOM

1 | PUBLIC ROOM

An upper cottage flat providing well-proportioned accommodation, driveway parking and south facing gardens within an excellent location between Ayr and Prestwick town centres.

Number 22 is an upper cottage flat suited to a range of potential buyers. The property does require modernisation but provides spacious accommodation with the added benefit of a long driveway and south facing gardens.

Features and benefits of the property include a modern three-piece shower room, gas central heating, good storage space including a large loft and double glazing.

Externally there is gated entry to the side onto a long driveway with space for several vehicles. The south facing rear garden is laid to lawn with a further area laid to decorative chips with garden shed included in the sale.



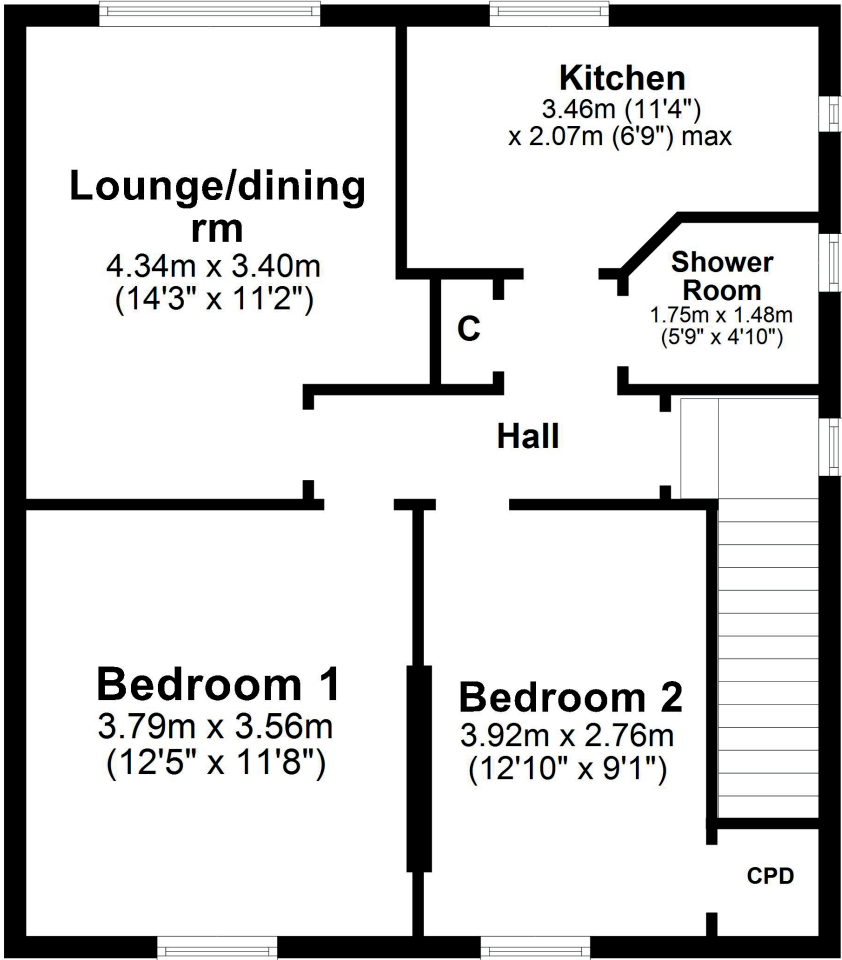

Heathfield Road is perfectly placed between Ayr and Prestwick town centre and within close proximity to a range of local amenities including shops and schooling while A6r and Prestwick town centres are around one mile distant and provide a more comprehensive range of amenities including supermarket and retail shopping, transport links and recreational facilities.

AY4642 | Sat Nav: 22 Heathfield Road, Ayr, KA8 9EA

For the full home report visit www.corumproperty.co.uk

* All measurements and distances are approximate Floorplans are for illustration purposes and may not be to scale.



WE'RE **SOLD** ON
YOUR FUTURE



Corum Ayr
10 Beresford Terrace, Ayr, KA7 2EG

Tel: 01292 880 888

Email: ayr@corumproperty.co.uk

www.corumproperty.co.uk