



71 CROFTHEAD ROAD

AYR

www.corumproperty.co.uk





3 | BEDROOMS

2 | BATHROOMS

2 | PUBLIC ROOMS

A spacious and extended detached family villa in Masonhill, with a large level plot, a detached garage, an additional downstairs en suite shower room and elevated views across Ayr and out to sea.

71 Crofthead Road offers to the market an excellent opportunity to purchase an impressive detached villa in the popular Masonhill area of Ayr. The property is set across a large level plot with a detached garage, ample off road parking and landscaped gardens that will suit a range of buyers.

The ground floor has been extended to create a larger downstairs bedroom with French doors to the rear and an additional en suite shower room. There is also an open plan lounge/ dining area and a kitchen on the ground floor and two further double bedrooms and a bathroom suite on the upper floor. This fantastic home has ample storage throughout and elevated views from the upstairs front window across Ayr town and across to Arran in the distance.

In more detail, the internal accommodation extends to an entrance porch, a hallway with stairs leading to the upper floor, a downstairs bedroom with French doors to the rear garden and an en suite shower room, a spacious lounge that is open plan into the dining area and a fitted kitchen, with a door out to the rear garden. On the upper floor there are two large double bedrooms, both with fitted wardrobes, and a family bathroom suite.

Externally the front garden is laid with lawn, decorative shrubs and a paved driveway leads along the side of the property to the detached garage. There is gated access at the side round to the fully enclosed rear garden, with a range of mature trees, lawn, a paved patio area and a garden shed.







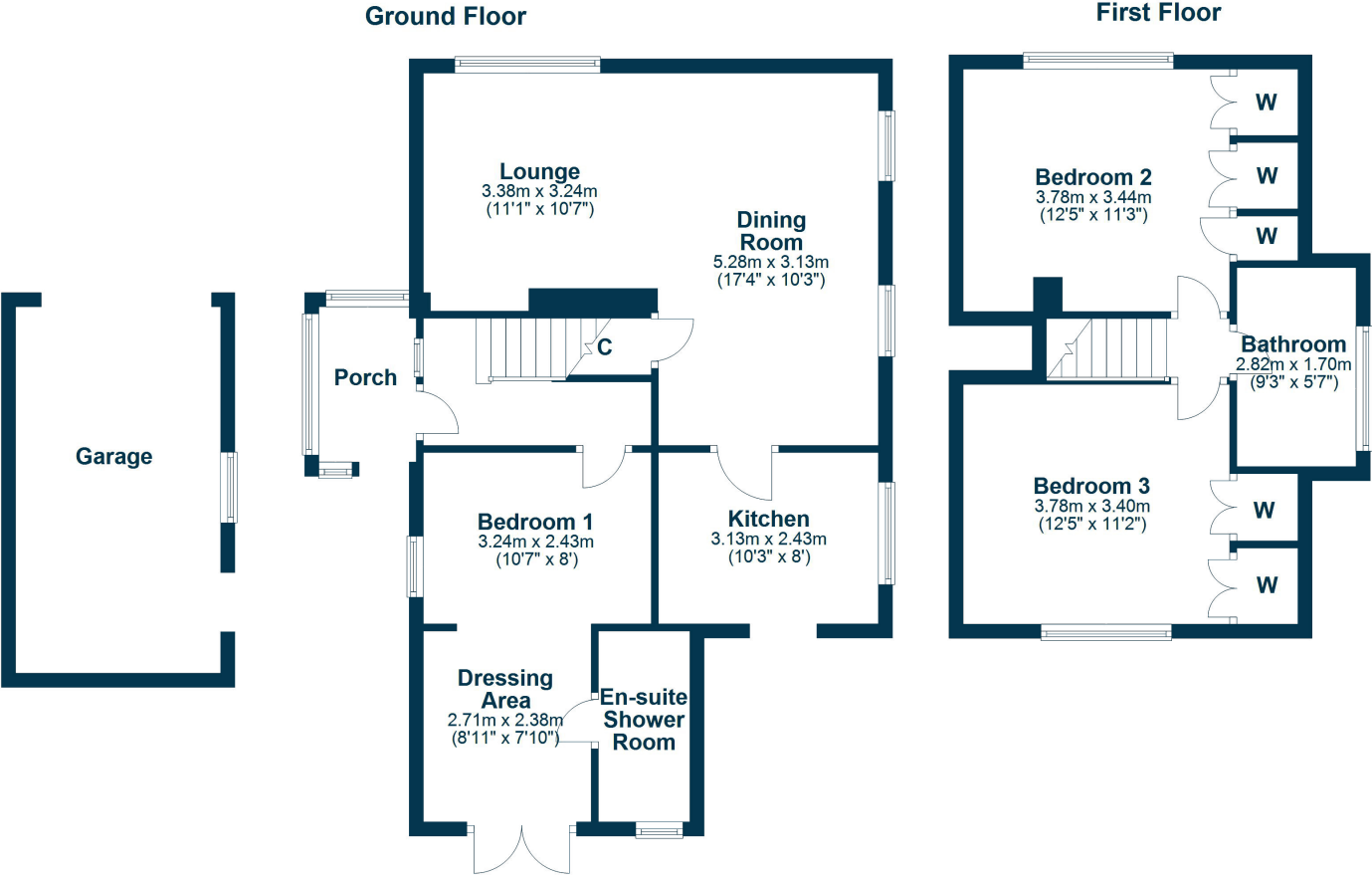

Masonhill is a popular residential area of Ayr and 71 Crofthead Road occupies a first class position within it. The market town of Ayr has a comprehensive range of local amenities, including schools, shops, restaurants and bars, transport links to Glasgow and beyond, supermarkets and leisure facilities.

AY4661 | Sat Nav: 71 Crofthead Road, Ayr, KA7 3NE

For the full home report visit www.corumproperty.co.uk

* All measurements and distances are approximate Floorplans are for illustration purposes and may not be to scale.



WE'RE **SOLD** ON
YOUR FUTURE



Corum Ayr
14 Beresford Terrace, Ayr, KA7 2EG

Tel: 01292 880 888

Email: ayr@corumproperty.co.uk

www.corumproperty.co.uk