



2/1, 2 ORMONDE COURT
NETHERLEE

www.corumproperty.co.uk





2 | BEDROOMS

1 | BATHROOM

2 | PUBLIC ROOMS

A lovely top floor apartment set within a popular residential development.

This traditional top floor flat enjoys a quiet yet convenient location within the popular suburb of Netherlee. Enjoying lovely open aspects and set within well maintained residents gardens, the subjects offer a great opportunity to the local marketplace.

Entered via secure buzzer entry system, and well-maintained residents' hallway / stairwell, the accommodation comprises of entrance hall, generous open plan lounge / dining room, fitted kitchen, two good double bedrooms, and main family bathroom. Specification includes gas central heating, double glazing and the subjects offer a great opportunity for investment / upgrading to suit the purchaser's taste.

Externally the property is set within well maintained resident's garden. On street parking to front.



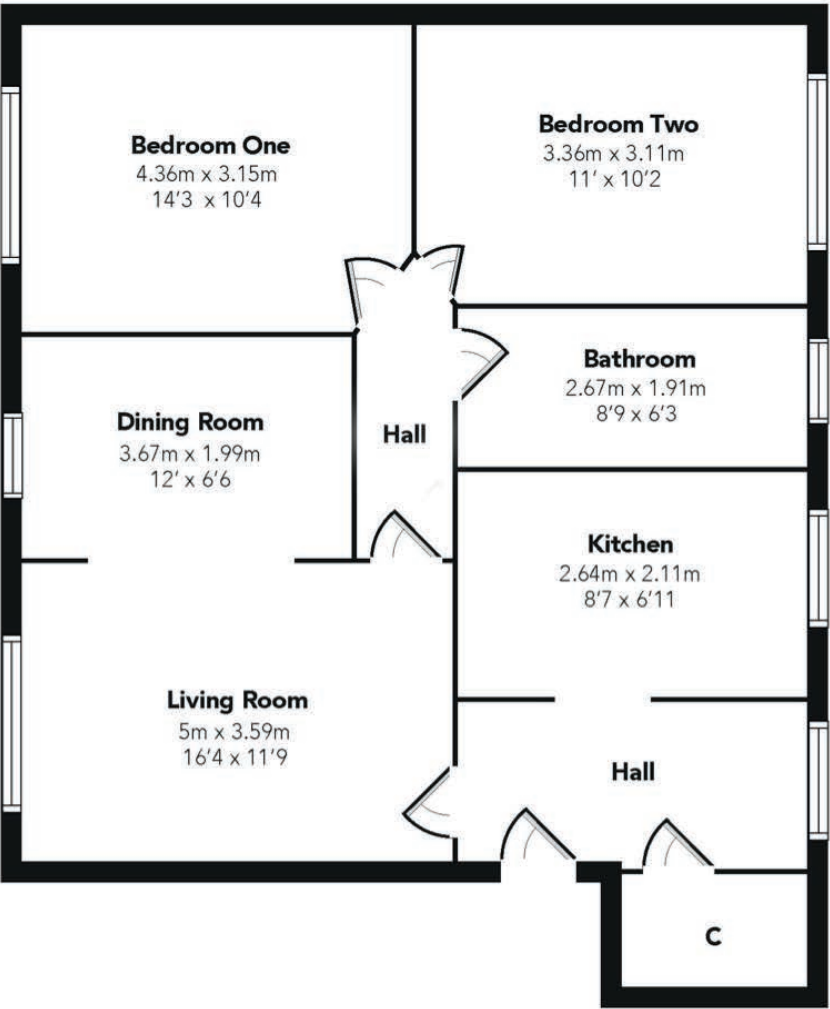

Netherlee is one of East Renfrewshire's most sought-after residential suburbs and is a haven for young growing families enjoying access to some of the best schooling within the local area. There is a full range of independent retailers including cafes and restaurants, and the district provides swift access via both road and rail to the city centre and beyond. There is a variety of places of worship found within the surrounding area and an array of sports and leisure activities including local parks, health clubs, gyms and golf courses close to hand in addition to equestrian pursuits.

CC0710 | Sat Nav: 2 Ormonde Court, Netherlee, G44

For the full home report visit www.corumproperty.co.uk

* All measurements and distances are approximate Floorplans are for illustration purposes and may not be to scale.



WE'RE **SOLD** ON
YOUR FUTURE



Corum Clarkston & Netherlee
5 Helena Place, Clarkston, G76 7RB

Tel: 0141 648 6000

Email: clarkston@corumproperty.co.uk

www.corumproperty.co.uk