



75 COLWOOD AVENUE

PARKHOUSE

www.corumproperty.co.uk



2 | BEDROOMS
1 | BATHROOM
1 | PUBLIC ROOM

A lovely, mid terrace villa set within a popular residential cul-de-sac.

- Popular location.
- Quiet residential cul-de-sac.
- Private and fully enclosed garden grounds.
- Modern kitchen and bathroom.
- Ample off street parking.

Amenities

Parkhouse is within close proximity to a full range of amenities, facilities, shops and popular schooling. The Dams to Darnley Country Park is only 300m from this home providing beautiful recreational space. There are excellent motorway networks to Glasgow and the Ayrshire coast and Silverburn shopping centre is just over 2 miles away. Just minutes from the A726 allowing access east to Paisley and Glasgow Airport and north via the M77 to Glasgow City Centre. Edinburgh can be reached in little over an hour. Both Nitshill and Priesthill & Darnley Railway Stations offer regular and direct services to both Glasgow and Barrhead.



Ground Floor
Approx. 20.9 sq. metres (225.4 sq. feet)

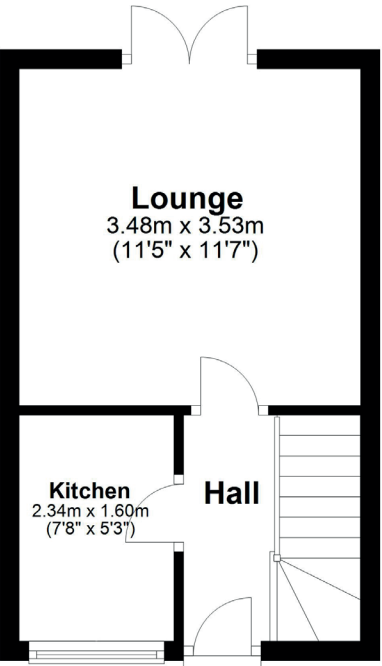

First Floor
Approx. 20.7 sq. metres (222.9 sq. feet)

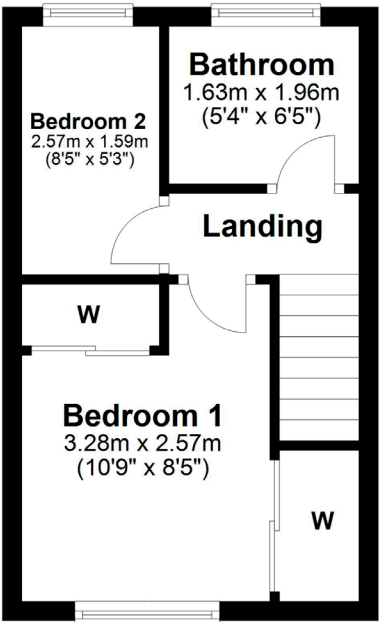

Sat Nav:
75 Colwood Avenue, Glasgow, G53 7XS

NM4176

*All measurements and distances are approximate.
Floorplans are for illustration purposes and may not be to scale.

For the full home report visit
www.corumproperty.co.uk



WE'RE **SOLD** ON
YOUR FUTURE



Corum Newton Mearns
134 Ayr Road, Newton Mearns, G77 6EG

Tel: 0141 639 5888

Email: n.mearns@corumproperty.co.uk

www.corumproperty.co.uk