



## 20 MEADOW RISE

NEWTON MEARNS

[www.corumproperty.co.uk](http://www.corumproperty.co.uk)







**3 | BEDROOMS**

**1 | BATHROOM**

**1/2 | PUBLIC ROOMS**

**A cleverly extended and reconfigured end terrace villa set within excellent garden grounds in the heart of Newton Mearns.**

Meadow Rise built by Mactaggart and Mickel is a highly sought after residential development within Newton Mearns. A quiet extended cul-de-sac style neighborhood provides this modern end terrace villa with a very peaceful setting which is sure to appeal to a range of buyers.

The complete accommodation extends to a welcoming reception hallway with WC and storage cupboard adjacent, fantastic bright formal lounge with folding doors through to extended family dining kitchen with the original kitchen location being used as a very useful utility nook. The extended dining/kitchen footprint accommodates a fully fitted modern kitchen with a range of wall and base mounted units including integrated appliances and provides garden access via French doors. Upstairs to the generous principal bedroom with fitted wardrobes, excellently proportioned second bedroom again benefiting from built in wardrobes, good third bedroom, modern fully tiled bathroom and wonderful landing cupboard. The specification includes a new gas central heating system, double glazing and the subjects are presented in neutral decorative tones with modern floor coverings.

Externally the property boasts some of the finest gardens within the development which are exceptionally private, level, fully enclosed and south facing.









#### GROUND FLOOR

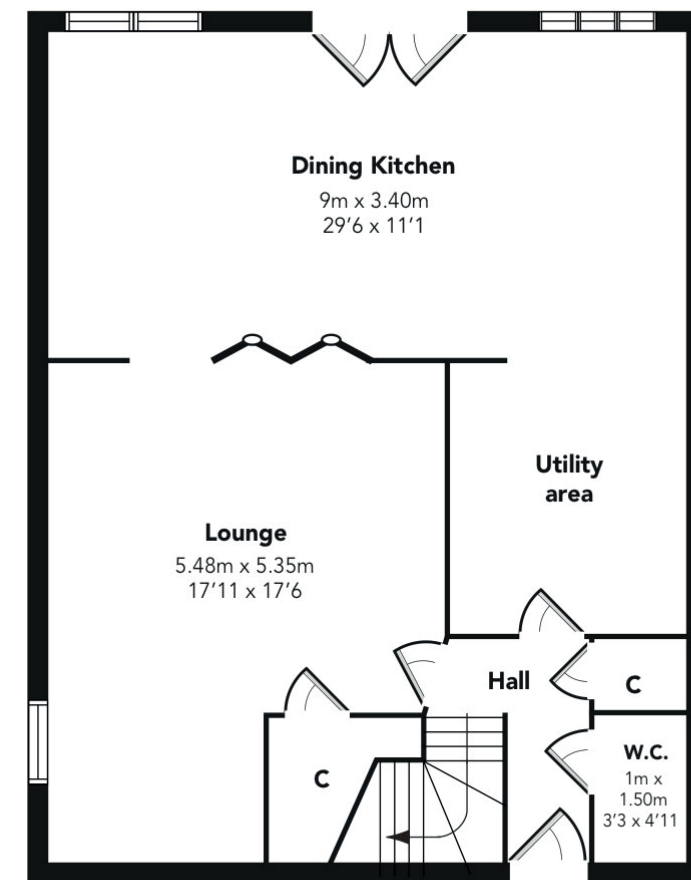

#### FIRST FLOOR

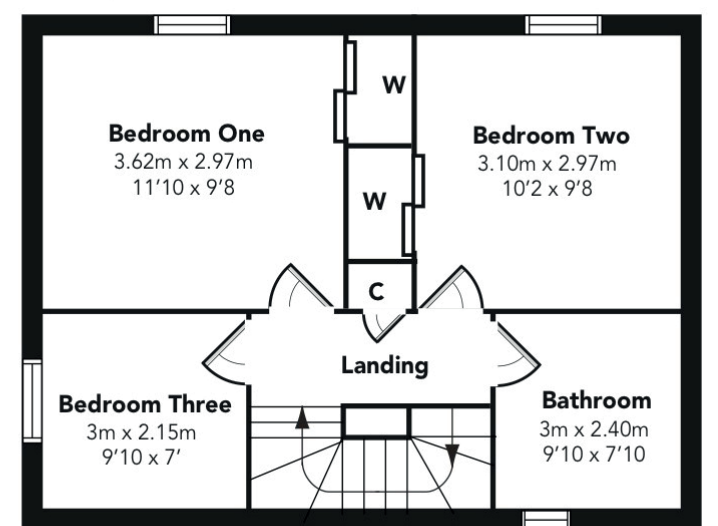

The property is extremely convenient for nearby amenities and nationally recognised schooling. Numerous shops and a variety of restaurants, supermarkets and independent retailers can be found at the nearby Mearns Cross Shopping Centre and Greenlaw Village. An abundance of sports and leisure facilities are available within East Renfrewshire including Parklands Country Club, David Lloyd Sports Club, Whitecraigs, East Renfrewshire and Eastwood Golf Clubs, Whitecraigs Tennis Club and Rouken Glen Park which was voted UK's Best Park of 2016, and there are also superb transport links close to hand (Patterson Station) which provide swift access to the city centre and Ayrshire. The property also has easy access to the M77, which also provides swift access to the city centre and the motorway network.

**NM4204** | Sat Nav: 20 Meadow Rise, Newton Mearns, G77 6SE

For the full home report visit [www.corumproperty.co.uk](http://www.corumproperty.co.uk)

\* All measurements and distances are approximate Floorplans are for illustration purposes and may not be to scale.





WE'RE **SOLD** ON  
YOUR FUTURE



Corum Newton Mearns  
134 Ayr Road, Newton Mearns, G77 6EG

**Tel:** 0141 639 5888

**Email:** [n.mearns@corumproperty.co.uk](mailto:n.mearns@corumproperty.co.uk)

[www.corumproperty.co.uk](http://www.corumproperty.co.uk)