



14 PARK COURT

PARK ROAD, GIFFNOCK

www.corumproperty.co.uk





2 | BEDROOMS

1 | BATHROOM

1 | PUBLIC ROOM

A spacious ground floor apartment set within delightful residents' gardens located in the high amenity suburb of Giffnock.

Number 14 Park Court occupies a quite idyllic and peaceful setting with Giffnock village only a short walk away and is set within delightful, private residents' garden grounds with large, sculpted lawns enjoying a south facing orientation. The property is perfect for a purchaser looking to enjoy all Giffnock has to offer whilst offering a secluded garden feel.

Reception hallway with generous storage, fitted kitchen with appliances, larger style L-shaped lounge/dining room with feature double windows to front overlooking south facing gardens, inner hallway with further storage giving access to two double sized bedrooms, both with storage provided and a main family bathroom with tiling and separate shower enclosure.

The property has a specification including security entrance system, gas central heating, double glazed windows and the property offers spacious accommodation internally.

Lawned garden grounds with residents' pathway giving access onto Park Road that leads directly to Giffnock amenities. Parking adjacent to the private gated access to the development. Private garage.



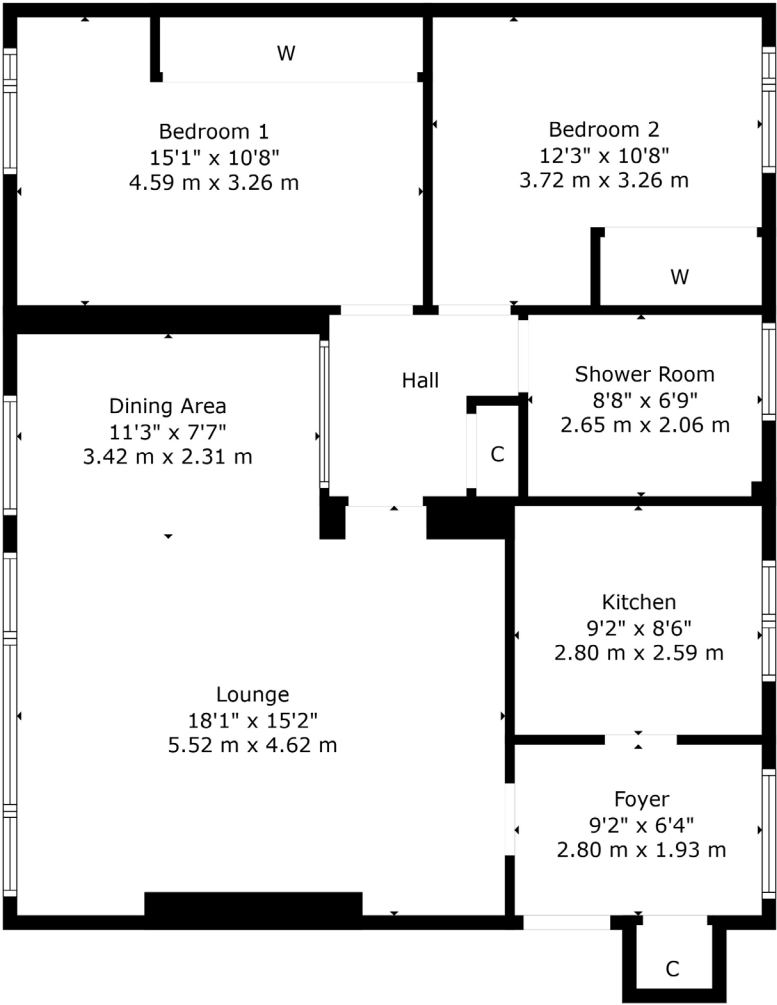

Giffnock continues to be one of the most desirable residential suburbs on Glasgow's south side. A haven for young growing families, the district is synonymous with some of the best schooling in the West of Scotland. Moreover, there are excellent transport links via bus and train close at hand, in addition to local motorway links (M77/M8) providing swift access to the city centre and Ayrshire. There are two train stations within close proximity, Muirend and Giffnock. There are numerous independent shops, restaurants and delicatessens only a short walk away. An abundance of sports and leisure facilities are available within East Renfrewshire including David Lloyd Sports Club, Nuffield Health Gym, Whitecraigs Golf Club, Giffnock and Whitecraigs Tennis Clubs and Rouken Glen Park which was voted UK's Best Park of 2016.

NM4205 | Sat Nav: 14 Park Court, Park Road, Giffnock, G46 7PB

For the full home report visit www.corumproperty.co.uk

* All measurements and distances are approximate Floorplans are for illustration purposes and may not be to scale.



WE'RE **SOLD** ON
YOUR FUTURE



Corum Newton Mearns
134 Ayr Road, Newton Mearns, G77 6EG

Tel: 0141 639 5888

Email: n.mearns@corumproperty.co.uk

www.corumproperty.co.uk