



# 1/1, 3 DEANSTON DRIVE

## SHAWLANDS

[www.corumproperty.co.uk](http://www.corumproperty.co.uk)





2 | BEDROOMS  
1 | BATHROOM  
1 | PUBLIC ROOM

A superb corner position flat set on the first floor of a blonde sandstone building and offering lovely open aspects across to Queens Park.

- Spacious first floor flat
- Large lounge and dining kitchen
- Two generous double bedrooms and bathroom
- Excellent storage throughout
- Gas central heating, double glazing, secure entry system
- Central Shawlands address

Amenities

3 Deanston Drive is within walking distance of local shops and amenities in central Shawlands where restaurants, bars and delicatessens can be found. More extensive facilities are available at the Morrison store at Newlands, the Marks & Spencer store at Queens Park or the Silverburn shopping centre at Pollok, a short drive to the west.

Recreational pursuits within the area are varied namely at Queens Park where nature walks, football pitches and tennis courts can be found.

Public transport services are available within central Shawlands via bus or rail, with Crossmyloof station being the closest.

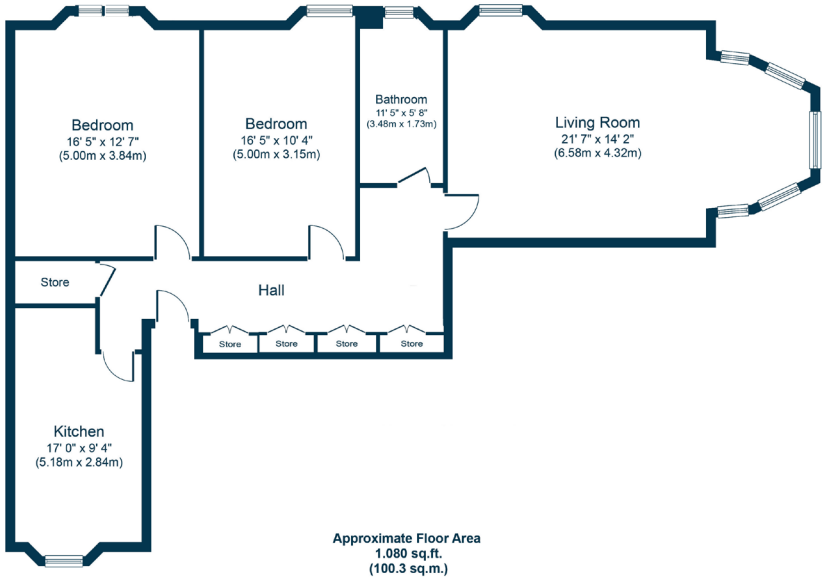

Sat Nav:  
1/1, 3 Deanston Drive, Shawlands, G41 3AF

SS4573

\*All measurements and distances are approximate.  
Floorplans are for illustration purposes and may not be to scale.

For the full home report visit  
[www.corumproperty.co.uk](http://www.corumproperty.co.uk)



WE'RE **SOLD** ON  
YOUR FUTURE



Corum Shawlands  
247 Kilmarnock Road, Shawlands, G41 3JF

Tel: 0141 636 7588  
Email: [shawlands@corumproperty.co.uk](mailto:shawlands@corumproperty.co.uk)

[www.corumproperty.co.uk](http://www.corumproperty.co.uk)