



WOODCROFT

TORR ROAD, BRIDGE OF WEIR

www.corumproperty.co.uk





2 | BEDROOMS

1 | BATHROOM

3 | PUBLIC ROOMS

A charming two bedroom bungalow commanding a spacious, elevated plot allowing for wonderful views over the river Gryffe.

'Woodcroft' is a charming, detached bungalow occupying an elevated and spacious plot on the rural fringes of Bridge of Weir allowing for wonderful views to the front over the river Gryffe. The property has been well maintained by the current owner and was reroofed circa 8 years ago with a modern central heating system but would benefit from a program of internal upgrading. The property currently offers spacious and versatile accommodation over one level and given the size of the plot and style of property, there will be scope to extend the property and convert the loft (subject to local planning consents) to enhance the accommodation to create the perfect family home. Viewing is essential to appreciate the wonderful position this home commands the potential it offers.

The property occupies an elevated position on Torr Road with a sweeping driveway, lined by manicured bushes, leading up to a parking area and to the single detached garage to the side of the property. The rear garden faces South West and is primarily made up of lawn with a raised decking bordered by mature trees and hedgerow.

The complete accommodation comprises of storm doors opening into an entrance vestibule and in to the 'L' shaped reception hallway thereafter. There are two large bay windowed rooms to the front currently used a lounge and principal bedroom, and two further rooms to the rear used a bedroom and a dining room. The kitchen is accessed via the dining room and boasts ample space for fitted cabinetry and appliances with access from there into the sunroom overlooking the rear garden. The spacious family bathroom has a fitted bath, separate shower cubicle, WC, and wash hand basin.



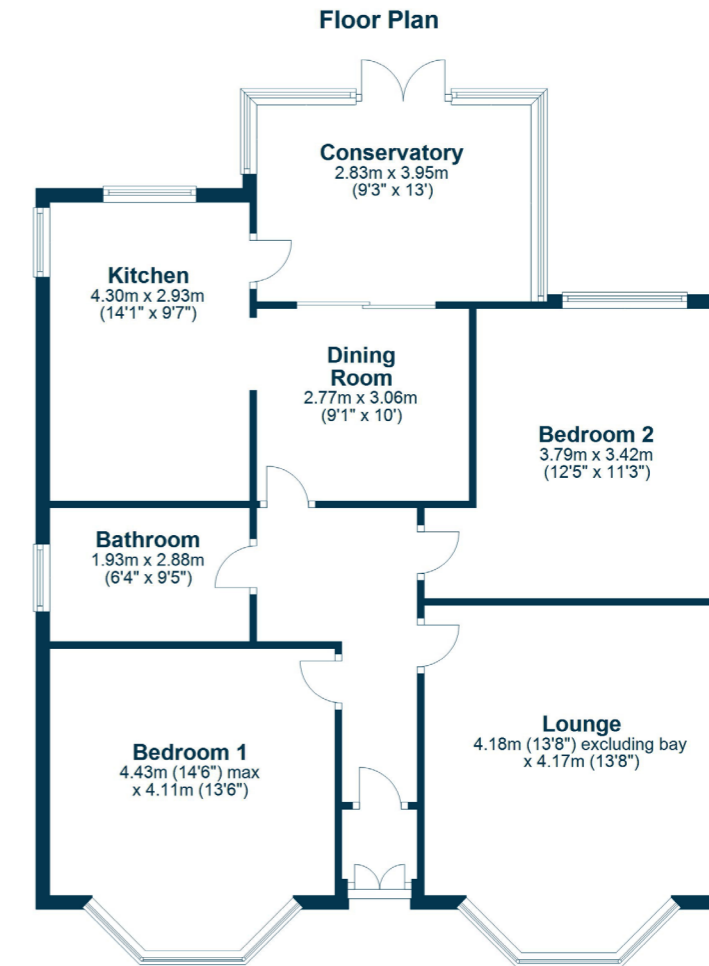

Bridge of Weir has good road links towards the M8 motorway, Glasgow International Airport and Glasgow City Centre. The village offers a wide range of local amenities including restaurants, shops, and a library. The village has a popular Primary School with a nursery and secondary education is at the prestigious Gryffe High School. There is also private schooling nearby at St. Columba's in Kilmacolm. The village has two 18 hole golf courses and there is fishing available on the River Gryffe.

BW2346 | Sat Nav: 'Woodcroft', Torr Road, Bridge of Weir, PA11 3BE

For the full home report visit www.corumproperty.co.uk

* All measurements and distances are approximate Floorplans are for illustration purposes and may not be to scale.



WE'RE **SOLD** ON
YOUR FUTURE



Corum Bridge Of Weir
2 Windsor Place, Main Street, Bridge Of Weir, PA11 3AF

Tel: 01505 691 400

Email: bridgeofweir@corumproperty.co.uk

www.corumproperty.co.uk