



18A EASWALD BANK

KILBARCHAN

www.corumproperty.co.uk



- 1 | BEDROOM
- 1 | BATHROOM
- 1 | PUBLIC ROOM

A charming one bedroom ground floor tenement flat in the heart of Kilbarchan.

- Traditional ground floor tenement flat
- Central hallway with large storage cupboard
- Bright bay windowed lounge
- Dining kitchen with fitted units and dining recess
- Modern fitted bathroom with three piece suite and shower over bath
- Double bedroom
- Private and communal gardens
- Gas fired central heating and double glazing

Amenities

Kilbarchan is a popular village with an abundance of amenities, including shops, pubs and restaurants and is also adjacent to the A737 (Howwood by-pass) which gives access to the M8 motorway and beyond towards Glasgow International Airport, INTU Retail Park and Glasgow City Centre.

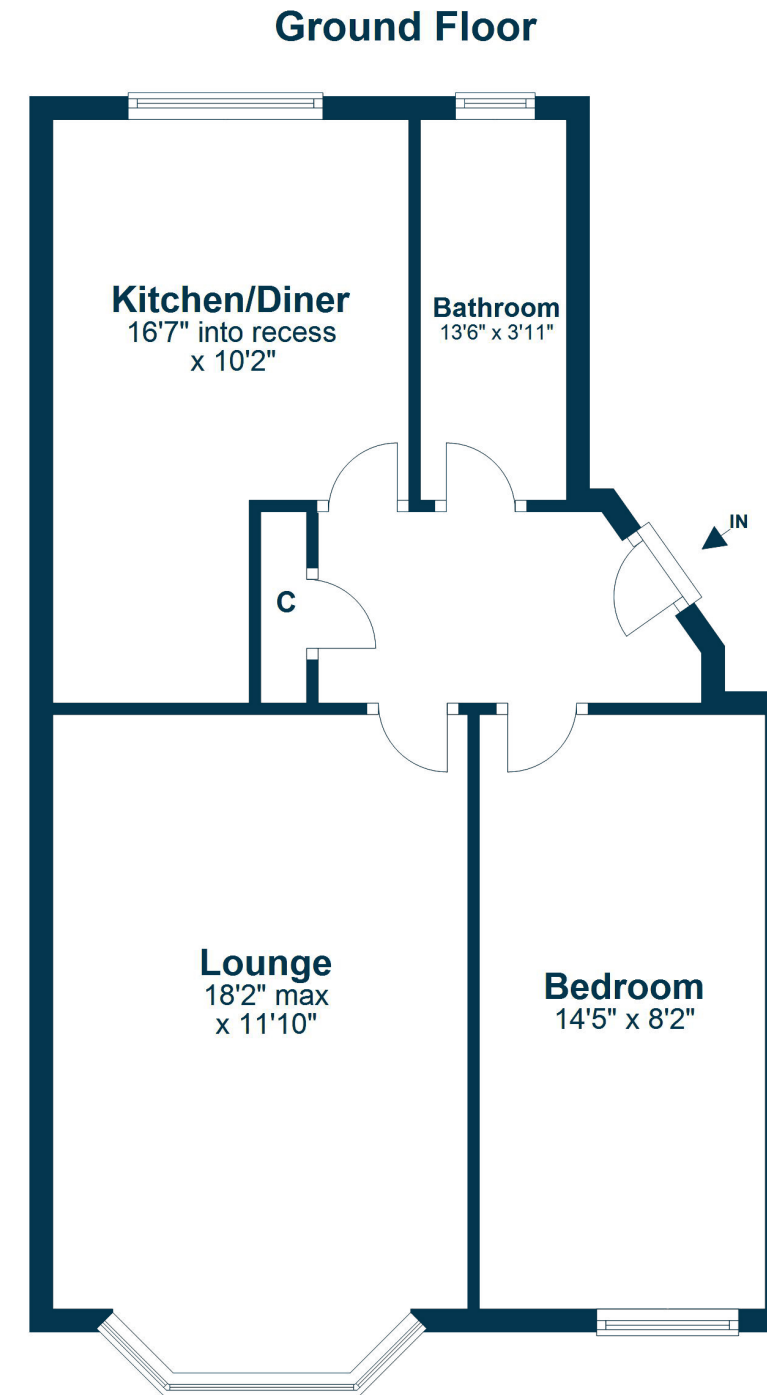
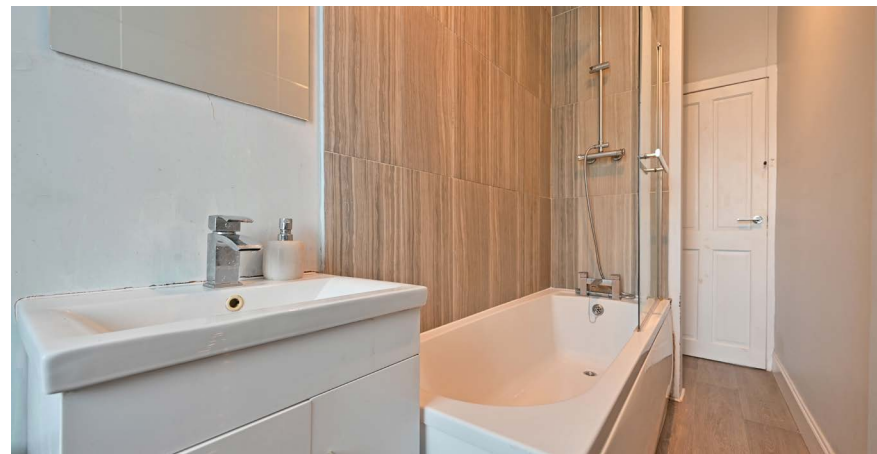

Sat Nav:
18A Easwald Bank, Kilbarchan, PA10 2AL

BW2354

*All measurements and distances are approximate.
Floorplans are for illustration purposes and may not be to scale.

For the full home report visit
www.corumproperty.co.uk



WE'RE **SOLD** ON
YOUR FUTURE

C O R U M

Corum Bridge Of Weir
2 Windsor Place, Main Street, Bridge Of Weir, PA11 3AF

Tel: 01505 691 400

Email: bridgeofweir@corumproperty.co.uk

www.corumproperty.co.uk