



0/2, 23 NITHSDALE ROAD

POLLOKSHIELDS

www.corumproperty.co.uk



1 | BEDROOM
1 | BATHROOM
1 | PUBLIC ROOM

An immaculate ground floor flat, comprehensively upgraded throughout, enjoying a highly convenient Strathbungo location.

- Double bedroom
- Large lounge
- Extensive storage
- Ground floor
- Well appointed kitchen

Amenities

23 Nithsdale Road is positioned within walking distance of shops and amenities upon Nithsdale Road and Kildrostan Street where thriving coffee shops, restaurants and delicatessens can be found. More extensive amenities are available at the Marks and Spencer's store at Queen's Park, the Sainsburys Local on Darnley Road, the Morrisons store at Crossmyloof, Giffnock or Newlands and The Avenue shopping mall in Newton Mearns. The shopping mall at Silverburn is a short drive to the West.

Recreational pursuits are varied namely at Clydesdale Cricket Club, Titwood Bowling and Tennis Club, Maxwell Park, Pollok Country Park where Pollok House and the world famous Burrell collection can be found, also Bellahouston Park.

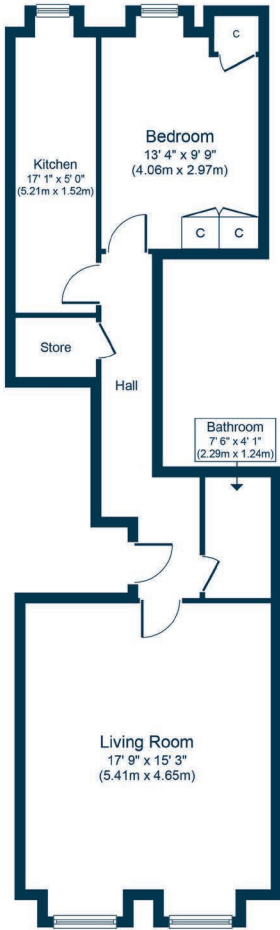

Sat Nav:
23 Nithsdale Road, Pollokshields, G41 2AL

SS4576

*All measurements and distances are approximate.
Floorplans are for illustration purposes and may not be to scale.

For the full home report visit
www.corumproperty.co.uk



WE'RE **SOLD** ON
YOUR FUTURE



Corum Shawlands
247 Kilmarnock Road, Shawlands, G41 3JF

Tel: 0141 636 7588

Email: shawlands@corumproperty.co.uk

www.corumproperty.co.uk