



1/1, 495 SHIELDS ROAD

POLLOKSHIELDS

www.corumproperty.co.uk



2 | BEDROOMS
1 | BATHROOM
1 | PUBLIC ROOM

An immaculately presented fully renovated upper conversion with a wealth of period features, enjoying a fantastic outlook, positioned close to amenities and transport links.

- Upper conversion
- Two double bedrooms
- Fabulous condition
- Contemporary styled fully fitted kitchen
- Stunning décor throughout

Amenities

The property is positioned within walking distance of a broad range of shops and amenities upon Nithsdale Road/Kildrostan Street, where coffee shops, restaurants and delicatessens are available. More extensive amenities can be found at the Morrisons’ store at Crossmyloof or the Silverburn shopping mall at Pollok, a short drive to the West.

Recreational pursuits within the area are varied namely at Maxwell Park or Pollok Park where nature walks/trails, Pollok House and the world famous Burrell Collection can be found.

Schooling is available locally at primary and secondary levels namely at Hutcheson’s Grammar and the local Gaelic School.

Frequent public transport services provide rapid commuter access to the city centre, the local railway station is a short distance away, whilst Shields Road underground station is also a short walk away.

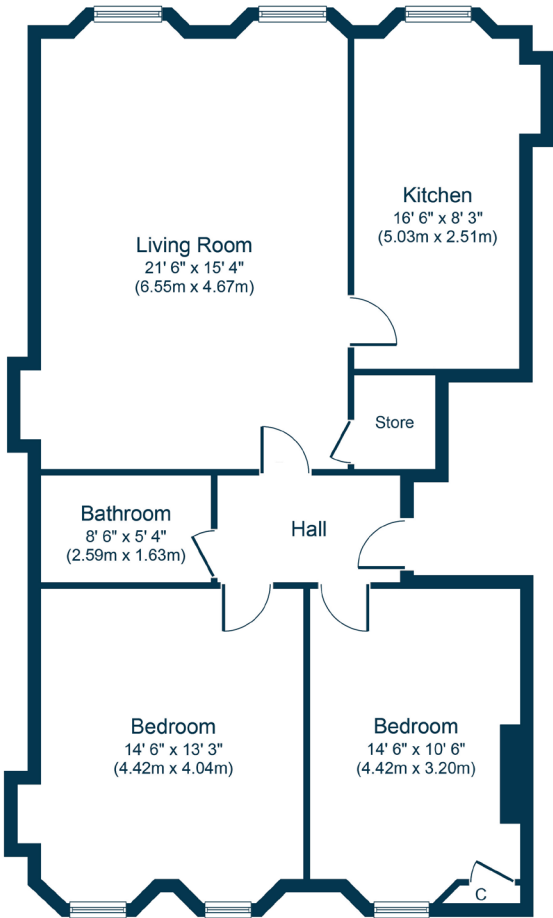

Sat Nav:
1/1, 495 Shields Road, Pollokshields, G41 2RF

SS4582

*All measurements and distances are approximate.
Floorplans are for illustration purposes and may not be to scale.

For the full home report visit
www.corumproperty.co.uk



WE'RE **SOLD** ON
YOUR FUTURE



Corum Shawlands
247 Kilmarnock Road, Shawlands, G41 3JF

Tel: 0141 636 7588

Email: shawlands@corumproperty.co.uk

www.corumproperty.co.uk