



**210 HARVIE AVENUE**

NEWTON MEARNs

[www.corumproperty.co.uk](http://www.corumproperty.co.uk)







**3 | BEDROOMS**  
**1 | BATHROOM**  
**2 | PUBLIC ROOMS**

**Extended and enhanced semi-detached villa with landscaped garden grounds.**

Corum are delighted to present to the market this larger style extended three bedroom semi-detached family home set within walking distance of nationally recognised schooling and local amenities.

A welcoming traditional reception hallway complete with storage provides access to the remainder of the home. An impressive formal lounge with feature fireplace and decorative panelling faces into private front gardens. The extended footprint of the home is situated to the rear and comprises of lovely dining room accessed via double doors from the Lounge which faces into the rear gardens and an enhanced kitchen space. The farmhouse styled kitchen comprises different sections of wall and base mounted units with ample storage and free-standing appliances and allows access to the gardens.

Upstairs the accommodation comprises of two excellent double bedrooms with ample space for a variety of furniture, a good third bedroom which could be used as office or studio space and the main family bathroom fitted with coordinated sanitary ware and tiling.

Externally the property sits in a generous plot with deep frontage, extended driveway, detached garage and landscaped rear grounds easily maintained by paved, stone and lawn sections.

The specification of the property includes upgraded central heating, wiring and roof system. The property has been lovingly maintained and presents an excellent opportunity to the marketplace.









GROUND FLOOR

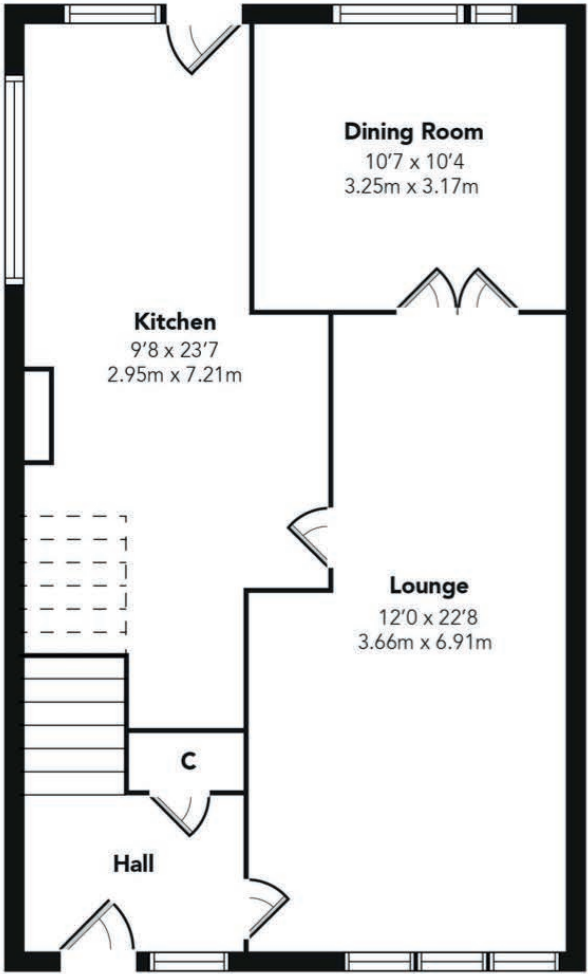

FIRST FLOOR

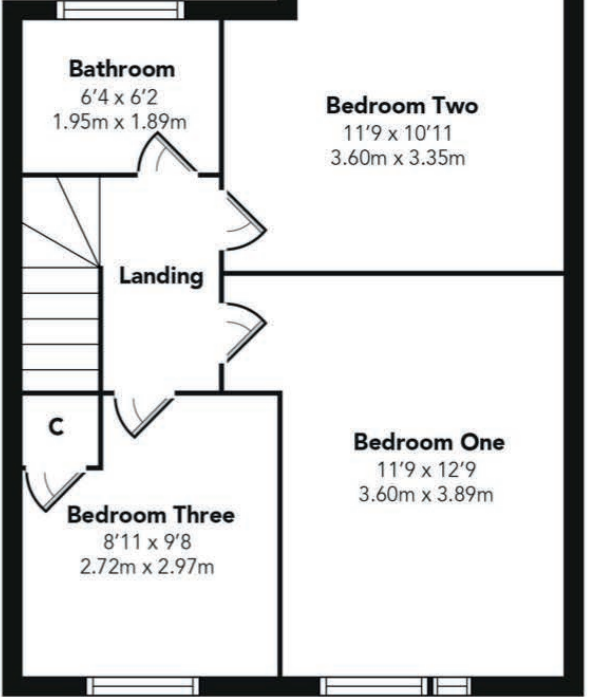

Situated within a highly sought after pocket of Newton Mearns, the property is superbly placed for a wide range of amenities and indeed nationally recognised schooling. A wide variety of restaurants, supermarkets and retailers can be found at the nearby Mearns Cross Shopping Centre and Greenlaw Village, and there are a range of sports and leisure activities found within the district including parks, health clubs, gyms and golf courses. Excellent local transport links providing swift access to the city centre and beyond are also close at hand with Whitecraigs Station being the nearest.

**NM4241** | Sat Nav: 210 Harvie Avenue, Newton Mearns, G77 6LL

For the full home report visit [www.corumproperty.co.uk](http://www.corumproperty.co.uk)

\* All measurements and distances are approximate Floorplans are for illustration purposes and may not be to scale.





WE'RE **SOLD** ON  
YOUR FUTURE



Corum Newton Mearns  
134 Ayr Road, Newton Mearns, G77 6EG

**Tel:** 0141 639 5888

**Email:** [n.mearns@corumproperty.co.uk](mailto:n.mearns@corumproperty.co.uk)

[www.corumproperty.co.uk](http://www.corumproperty.co.uk)