



0/1 12 CRESSWELL STREET
HILLHEAD

www.corumproperty.co.uk





2 | BEDROOMS
1 | BATHROOM
1 | PUBLIC ROOM

Flat 0/1 12 Cresswell Street is a superb, two bedroom elevated ground floor flat in the heart of Glasgow's West End, perfectly located for ease of access to all the local amenities that Byres Road has to offer.

Entrance to the building is via an immaculate communal residents' hallway and the internal accommodation comprises; large welcoming reception hallway with two good sized storage cupboards, stunning bay windowed lounge with focal fireplace and extra storage room, two good sized double bedrooms, that both have original detailed fireplaces, and an impressive large modern dining kitchen with high specification appliances. There is a stunning family bathroom with separate shower that completes the accommodation on offer.

The flat has modern electric heating system (Roainte D series), secure entry system and communal garden to the rear.



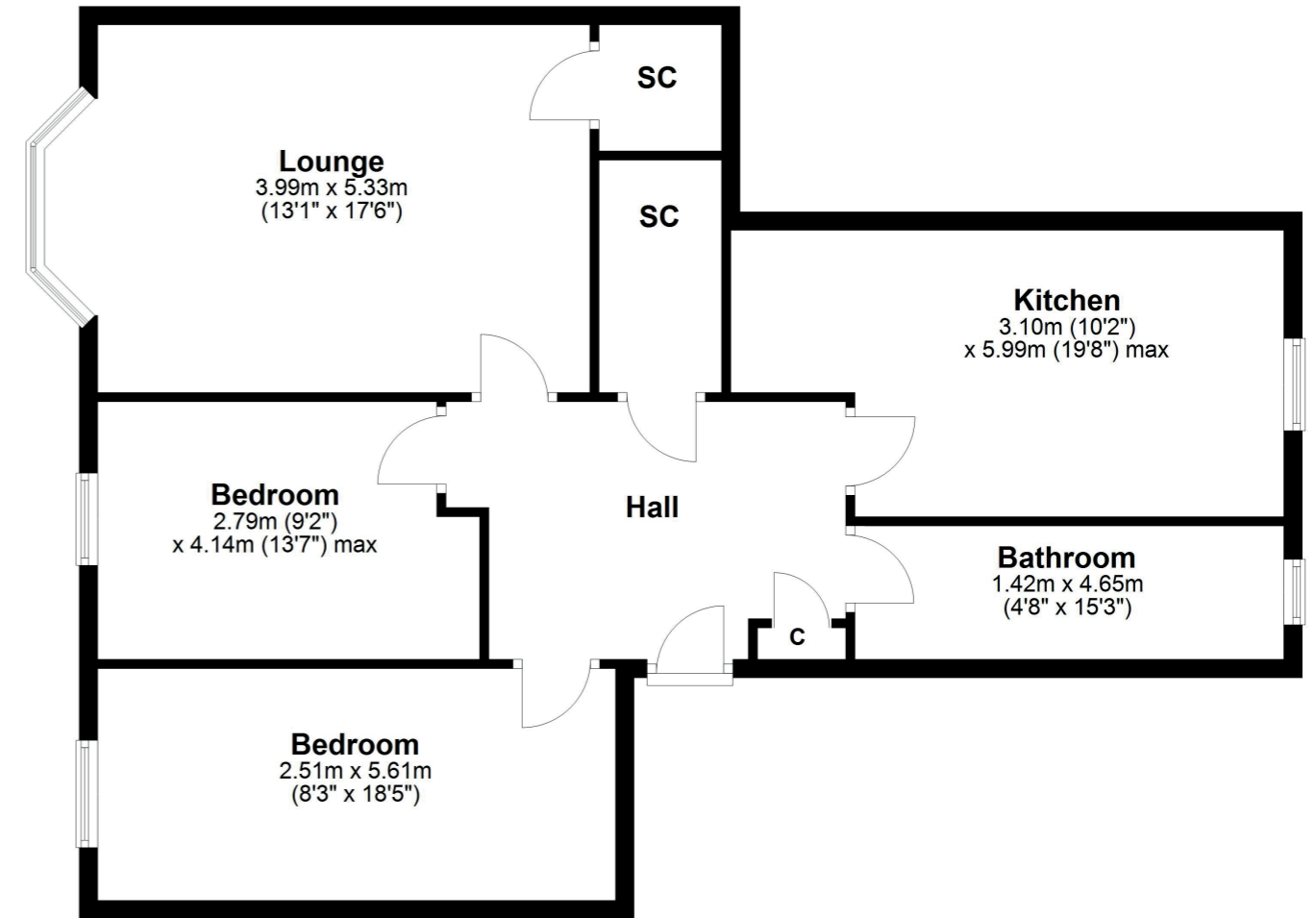

Hillhead is centrally located within the West End, close to Glasgow University. The main street, Byres Road, offers a wide selection of shops, cafés and supermarkets including Tesco Metro, Marks & Spencer and Waitrose. The famous Ashton Lane is situated just off Byres Road offering various bars, restaurants and the Grosvenor Cinema.

The recently refurbished Hillhead Underground on Byres Road provides swift access to Glasgow City Centre and regular bus services operate on Byres Road and Great Western Road. There are also good road links to the motorway network and Glasgow International Airport.

WE4936 | Sat Nav: 12 Cresswell Street, Hillhead, G12 8BY

For the full home report visit www.corumproperty.co.uk

* All measurements and distances are approximate Floorplans are for illustration purposes and may not be to scale.



WE'RE **SOLD** ON
YOUR FUTURE



Corum West End
82 Hyndland Road, Glasgow, G12 9UT

Tel: 0141 357 1888

Email: westendenq@corumproperty.co.uk

www.corumproperty.co.uk