



133 GLENDALE CRESCENT

AYR

www.corumproperty.co.uk





3 | BEDROOMS

1 | BATHROOM

2 | PUBLIC ROOMS

Number 133 is a highly sought after three bedroom terraced villa with private gardens and monoblock driveway, located within the popular Belmont district of Ayr. Features include a new dining kitchen, quartz worktops, appliances, pet/child friendly gardens

In summary, the property comprises an entrance hallway with under stairs storage cupboard, a bright and spacious lounge plus a modern fitted kitchen with door access onto the enclosed rear gardens.

The kitchen is complete with tasteful shaker style units and benefits from extremely stylish quartz worktops, integrated appliances and an open plan dining area. A staircase from the entrance hall gives access to the first floor which has two double bedrooms and a single bedroom as well as a modern bathroom with three piece suite bath, shower over bath. The property is complete with gas central heating, double glazing.

Externally there are well maintained gardens to the rear and ample off street parking on a monoblock driveway to the front.

Properties like this within sought after locations attract a high level of viewers so early viewing is essential.



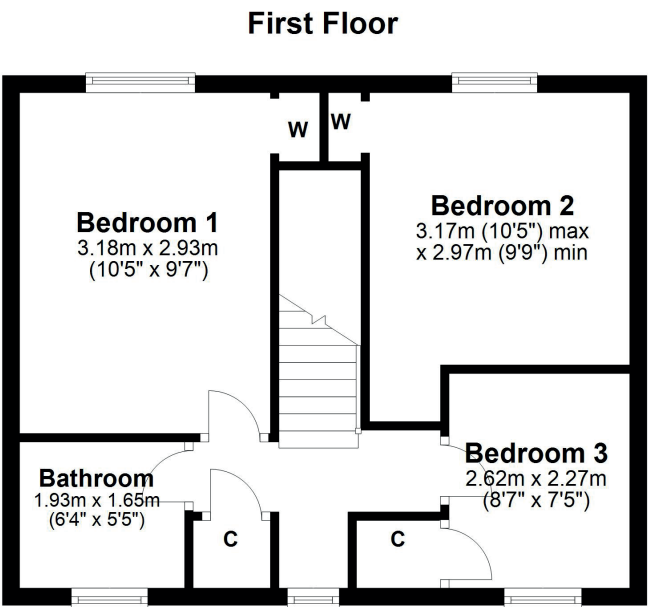
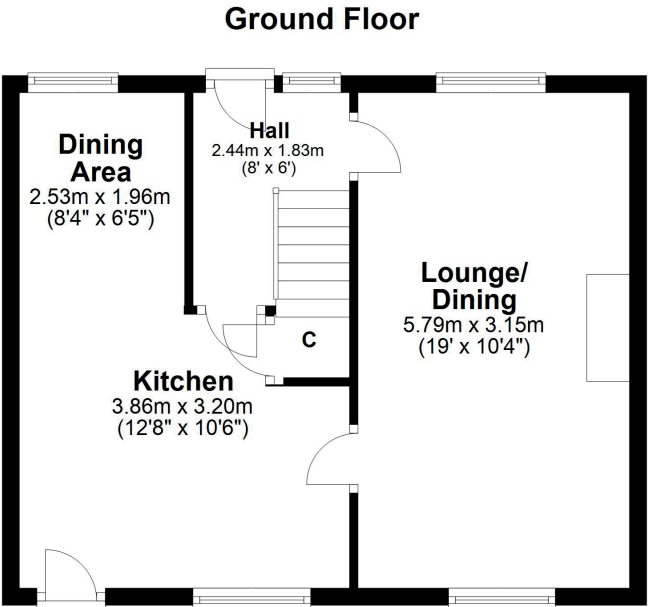

Glendale Crescent is a first class location forming part of the highly regarded Belmont Academy school catchment. It is conveniently placed for access to local shops at Mount Oliphant Crescent and a short distance from the town centre which retains a comprehensive range of supermarket and retail shops, transport, and wide range of recreational facilities.

AY4770 | Sat Nav: 133 Glendale Crescent, Ayr, KA7 3RU

For the full home report visit www.corumproperty.co.uk

* All measurements and distances are approximate Floorplans are for illustration purposes and may not be to scale.



WE'RE **SOLD** ON
YOUR FUTURE



Corum Ayr
10 Beresford Terrace, Ayr, KA7 2EG

Tel: 01292 880 888

Email: ayr@corumproperty.co.uk

www.corumproperty.co.uk