



2/2, 2 NORVAL PLACE

KILMACOLM

www.corumproperty.co.uk





2 | BEDROOMS

1 | BATHROOM

1 | PUBLIC ROOM

A stunning two bedroom apartment occupying a top floor position in this attractive traditional building convenient for the centre of the lovely village of Kilmacolm.

A beautifully presented flat occupying a second floor position in a traditional building on Moss Road in the village centre. The building features a security entry system, a communal rear garden and the flat has a basement cellar for storage. The specification includes a fitted kitchen, modern flooring and décor, a gas fired central heating system and double glazing.

The accommodation comprises of a broad hallway configured as a dining area with entry to the charming lounge with a large front facing window and a fire surround with a gas fire. The kitchen has fitted furniture with space for freestanding appliances and rear views over the village. There are two double bedrooms with fitted wardrobes in the main bedroom. The bathroom contains a large walk in shower, a separate bath and a store cupboard. The wc is separate and positioned off the hall.



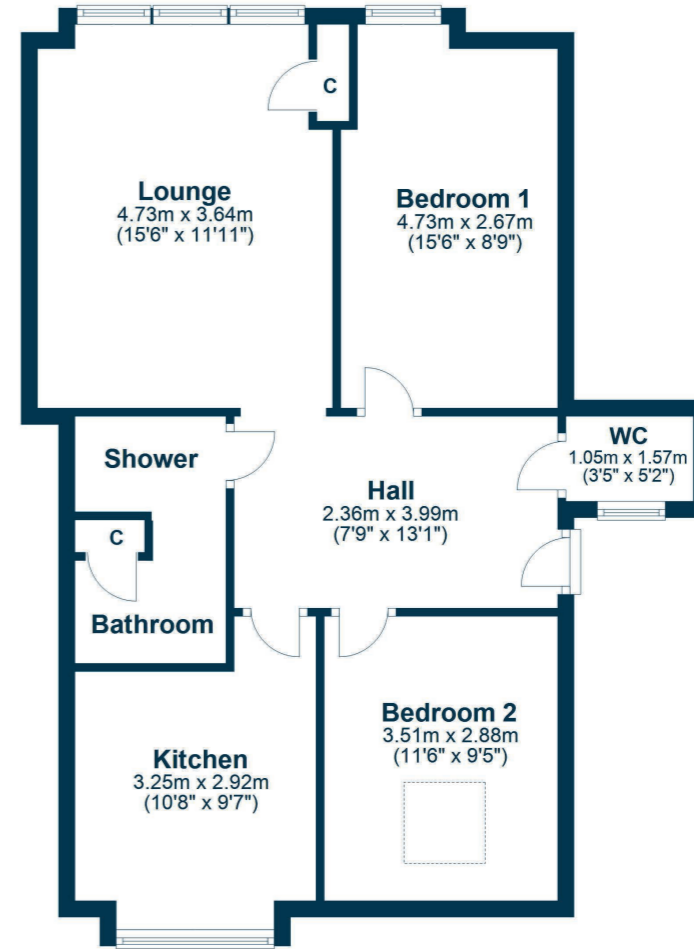

Kilmacolm is a highly sought after village positioned in the heart of the Gryffe valley. The village offers an excellent range of shops, cafes and restaurants. Local schooling includes Kilmacolm Nursery and Primary School with secondary education at the modern Port Glasgow High School Campus. The village is home to the independent Duchal Nursery School and the prestigious St. Columba's School. The sporting and leisure amenities are varied with a tennis club, bowling club, the picturesque Kilmacolm Golf Club, Birkmyre Park playing fields and gym, local fisheries and angling at Knapps Loch and the River Gryffe.

BW2381 | Sat Nav: 2/2, 2 Norval Place, Kilmacolm, PA13 4AQ

For the full home report visit www.corumproperty.co.uk

* All measurements and distances are approximate Floorplans are for illustration purposes and may not be to scale.



WE'RE **SOLD** ON
YOUR FUTURE



Corum Bridge Of Weir
2 Windsor Place, Main Street, Bridge Of Weir, PA11 3AF

Tel: 01505 691 400

Email: bridgeofweir@corumproperty.co.uk

www.corumproperty.co.uk