



FLAT 12, AIKENHEAD HOUSE

325 CARMUNNOCK ROAD, KING'S PARK

www.corumproperty.co.uk



2 | BEDROOMS
1 | BATHROOM
1 | PUBLIC ROOM

Set within historic mansion house known as Aikenhead House, this fabulous two bedroom flat enjoys a fantastic location set within well maintained local parkland with residents and visitor parking located to front.

- Two bedrooms
- Large Open Plan living space
- Converted A-listed Mansion steeped in history
- Parkland location - 68-acre King's Park, Communal gardens private to the house
- Secure Entrance System

Amenities

The property is positioned within walking distance of shops and amenities upon Carmunnock Road and Old Castle Road, and further afield on Battlefield Road, Clarkston Road, and Kilmarnock Road where thriving coffee shops, restaurants and delicatessens can be found. More extensive amenities are available at the Asda store Toryglen, Sainsbury store at Muirend or the Kingsgate Retail Mall at East Kilbride a short drive to the southwest.

Recreational pursuits are varied including well maintained municipal parks, health clubs/gyms, golf courses both public and private.

Excellent local schooling at both primary and secondary level is available within walking distance.

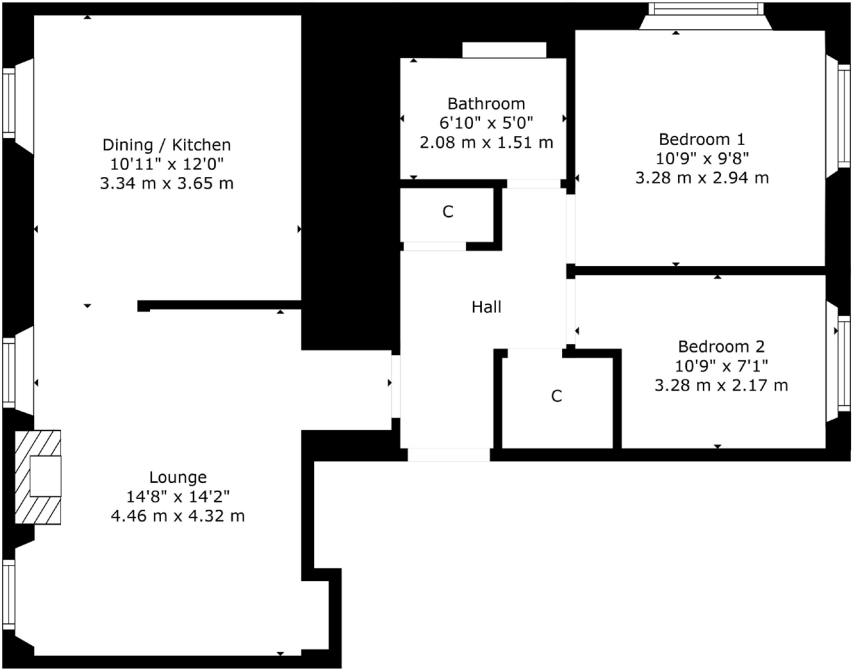

Sat Nav:
325 Carmunnock Road, King's Park, G44 5HL

SS4667

*All measurements and distances are approximate.
Floorplans are for illustration purposes and may not be to scale.

For the full home report visit
www.corumproperty.co.uk



WE'RE **SOLD** ON
YOUR FUTURE



Corum Shawlands
247 Kilmarnock Road, Shawlands, G41 3JF

Tel: 0141 636 7588

Email: shawlands@corumproperty.co.uk

www.corumproperty.co.uk