



3/1, 35 SOMERVILLE DRIVE

MOUNT FLORIDA

www.corumproperty.co.uk



1 | BEDROOM
1 | BATHROOM
1 | PUBLIC ROOM

A beautifully presented one bedroom flat boasting expansive views.

- Red Sandstone building
- Bay window lounge, open plan to kitchen
- Double bedroom
- Hallway with storage
- Modern bathroom

Amenities

35 Somerville Drive is positioned within minutes’ walk of local shops and amenities upon Cathcart Road and Battlefield Road, whilst more extensive amenities are available within central Shawlands, the 24-hour Asda Store on Prospecthill Road or the Morrisons store at Crossmyloof. Queens Park is a short distance away providing recreational space as well as tennis courts and all-weather football pitches.

Frequent public transport services provide rapid commuter access to the city centre, the local railway station at Mount Florida is approximately half a mile away.

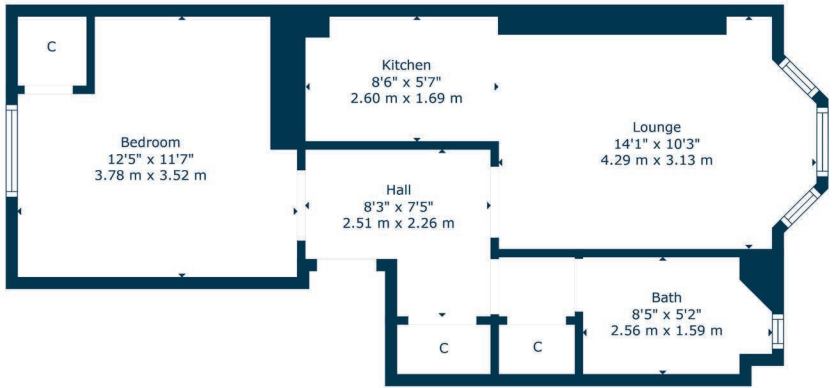

Sat Nav: 3/1 35 Somerville Drive, Mount Florida, G42 9BG

SS4669

*All measurements and distances are approximate.
Floorplans are for illustration purposes and may not be to scale.

For the full home report visit
www.corumproperty.co.uk



WE'RE **SOLD** ON
YOUR FUTURE



Corum Shawlands
247 Kilmarnock Road, Shawlands, G41 3JF

Tel: 0141 636 7588

Email: shawlands@corumproperty.co.uk

www.corumproperty.co.uk