



# 20 MOUNT STUART STREET

## SHAWLANDS

[www.corumproperty.co.uk](http://www.corumproperty.co.uk)





2 | BEDROOMS  
1 | BATHROOM  
1 | PUBLIC ROOM

Occupying a private main door position in the centre of Shawlands, this traditional two-bedroom flat will be of particular interest to buyers keen to have their own outdoor space. The property has been meticulously cared for by our client and it represents a terrific opportunity to live on the doorstep of all that Shawlands has to offer.

- Main door flat in centre of Shawlands
- Excellent fitted dining sized kitchen
- Two double sized bedrooms
- Gas central heating & double glazing
- Tailored front garden with space for seating
- Superb location for amenities & transport

Amenities

20 Mount Stuart Street is in very close proximity to thriving shops, bars, coffee houses, bakeries and restaurants. Sainsbury's, Tesco, Co-op and M&S stores are all within half a mile of the property. The fringe of Queen's Park hosts a Farmers' Market on the 1st and 3rd Saturday of each month, whilst recreational space, tennis courts and football pitches are readily available within the park. Shawlands Civic Square is also nearby, designed to offer a destination for markets, dance, craft events, speakers and debate.

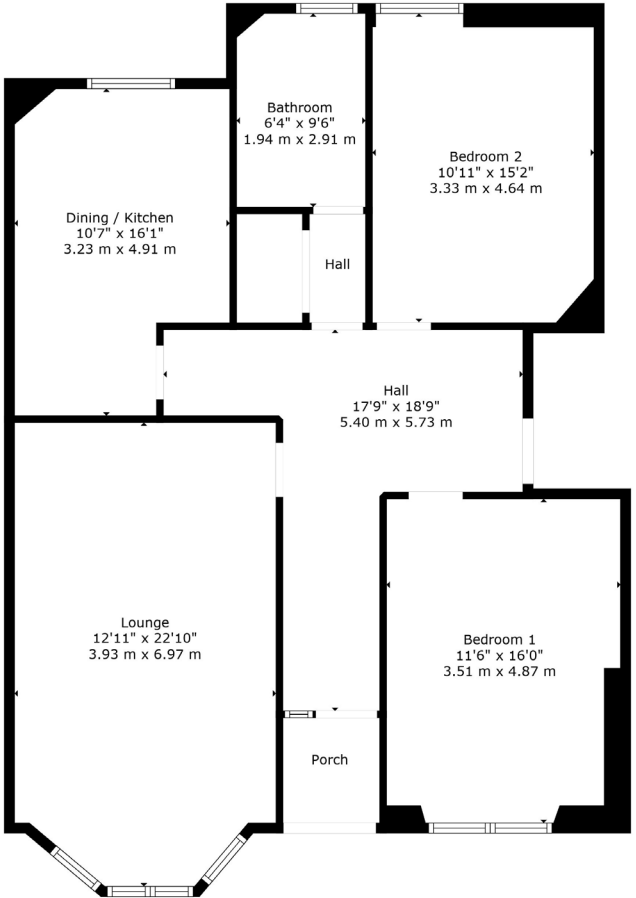

Sat Nav:  
20 Mount Stuart Street, Shawlands, G41 3YL

SS4682

\*All measurements and distances are approximate.  
Floorplans are for illustration purposes and may not be to scale.

For the full home report visit  
[www.corumproperty.co.uk](http://www.corumproperty.co.uk)



WE'RE **SOLD** ON  
YOUR FUTURE



Corum Shawlands  
247 Kilmarnock Road, Shawlands, G41 3JF

**Tel:** 0141 636 7588

**Email:** shawlands@corumproperty.co.uk

[www.corumproperty.co.uk](http://www.corumproperty.co.uk)