



2/2, 120 LOCHLEVEN ROAD
BATTLEFIELD

www.corumproperty.co.uk



2 | BEDROOMS
1 | BATHROOM
1 | PUBLIC ROOM

Occupying a bright position in the Battlefield district, this two bed flat delivers period features and attractive qualities. Originally dating from the early 1900s, the property has been cared for by our client and is well presented for sale.

- Bright second floor tenement flat
- Bay windowed lounge with open views
- Fitted kitchen accessed from lounge
- Two double sized bedrooms
- Some period features retained
- Excellent amenities within 500 yards

Amenities

120 Lochleven Road is within half a mile of the numerous independent coffee houses, restaurants, bars and shops in Battlefield. Recreational pursuits are available locally at Queens Park or nearby at the Battlefield Community Garden where residents of the area regularly socialise. Mount Florida train station is also within half a mile of the front door providing several services an hour into Glasgow central station.

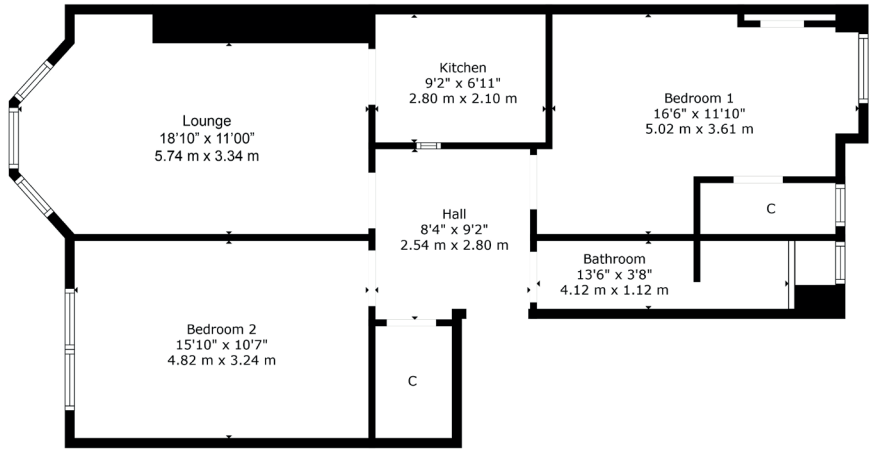

Sat Nav:
120 Lochleven Road, Battlefield, G42 9SJ

SS4733

*All measurements and distances are approximate.
Floorplans are for illustration purposes and may not be to scale.

For the full home report visit
www.corumproperty.co.uk



WE'RE **SOLD** ON
YOUR FUTURE



Corum Shawlands
247 Kilmarnock Road, Shawlands, G41 3JF

Tel: 0141 636 7588

Email: shawlands@corumproperty.co.uk

www.corumproperty.co.uk