



4 GLENBANK COURT

GLENBANK DRIVE, THORNLIEBANK

www.corumproperty.co.uk



2 | BEDROOMS

2 | BATHROOMS

1 | PUBLIC ROOM

Beautifully appointed first floor apartment which provides generous space, great flexibility and offers a fantastic opportunity to the local marketplace.

- A lovely first floor modern flat, set within a private residential development near many local amenities.
- Two double bedrooms
- Spacious dining kitchen.
- En-suite shower room.
- Flexible accommodation.
- Residents' parking and gardens.
- Excellent proximity to amenities and transport links.

Amenities

The high amenity district of Thornliebank offers an extensive range of amenities including shopping facilities from a range of local and national retailers, and a regular train service from Thornliebank Train Station offers quick and convenient access to both Glasgow city centre and the surrounding suburbs of Glasgow. Local schooling includes Thornliebank Primary School, Woodfarm High School, Our Lady of the Missions Primary School and St Ninian's High School. Thornliebank is also located just a short distance from the excellent facilities of nearby highly sought after Giffnock and indeed Rouken Glen Park. The area provides an abundance of sports and recreational facilities including a variety of local golf courses, David Lloyd Leisure Centre, sports clubs and multiple public parks.

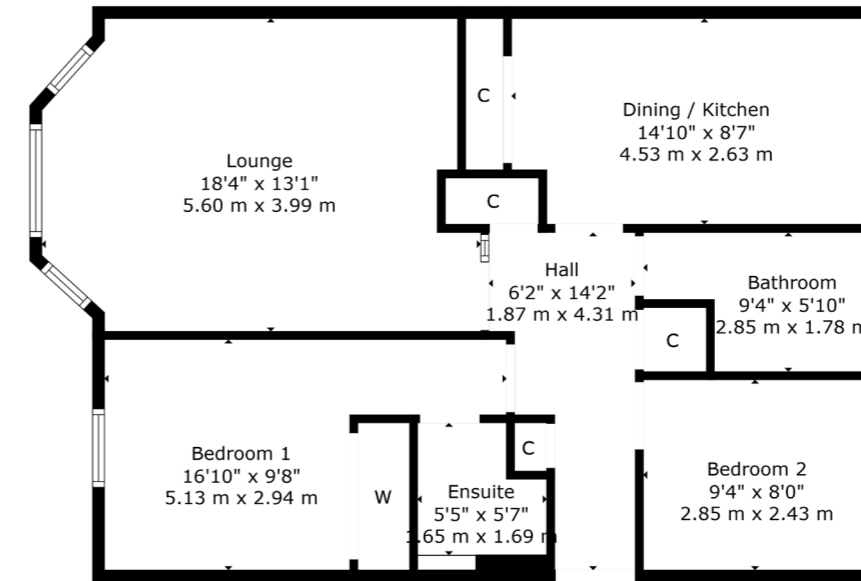

Sat Nav:
4 Glenbank Court, Glenbank Drive, Thornliebank G46 7EJ

NM4490

*All measurements and distances are approximate.
Floorplans are for illustration purposes and may not be to scale.

For the full home report visit
www.corumproperty.co.uk



WE'RE **SOLD** ON
YOUR FUTURE



Corum Newton Mearns
134 Ayr Road, Newton Mearns, G77 6EG

Tel: 0141 639 5888

Email: n.mearns@corumproperty.co.uk

www.corumproperty.co.uk