



5A KILLERMONT VIEW

GLASGOW

www.corumproperty.co.uk





2 | BEDROOMS

1 | BATHROOM

1 | PUBLIC ROOM

This tastefully finished, two bedroom, ground floor flat is situated within a popular residential development beside the River Kelvin, just over the Bearsden boundary at Killermont.

The accommodation comprises:- welcoming entrance hall, with large cupboard, spacious lounge, providing ample space for a dining table and benefitting from a pleasant outlook to the front of the property. There is a well appointed kitchen, which is accessed from the lounge, featuring white high gloss units, a stained butcher block worktop and a stylish 'Belfast' sink. Two double bedrooms enjoy a quiet position to the rear of the property, with both benefitting from built in wardrobes, featuring sliding mirrored doors. Finally, the bathroom has recently been upgraded, to include on trend marble effect wall tiles, electric shower, positioned over the bath, and a gloss white vanity unit, under the sink.

The property further benefits from double glazing throughout, an upgraded electric heating system and secure door entry system.

Externally, there is an enclosed drying area, to the side of the property, and ample residents' only parking, to the front. Furthermore, Killermont View is an exceptionally well maintained development, with a range of a tidy lawns, mature trees and neat flowerbeds.



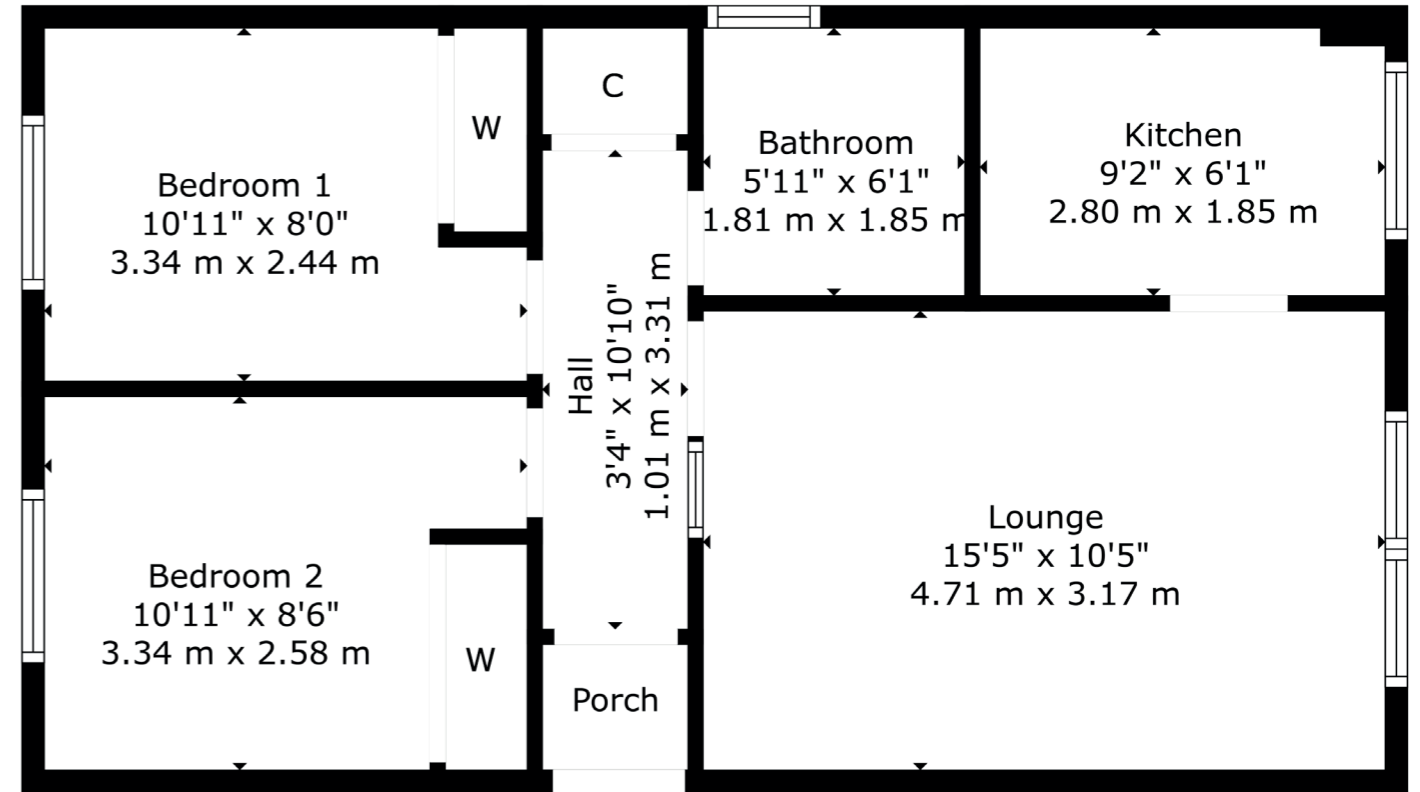

The neighbouring suburb of Bearsden is one of Glasgow's most desired districts in which to reside. Leisure facilities are plentiful, with a choice of private and state gyms and clubs in abundance. There is an excellent selection of shops and services at Bearsden Cross along with restaurants, cafes and bars. There are excellent bus links nearby and train stations can be found at Maryhill, Hillfoot, Westerton and Bearsden, providing regular services into Glasgow's West End and City Centre, including a service to Edinburgh.

Glasgow Airport can be reached within twenty-five minutes off peak and, to the north of Bearsden is the world renowned Loch Lomond and The Trossachs National Park.

BD3831 | Sat Nav: 5 Killermont View, Glasgow, G20 0TZ

For the full home report visit www.corumproperty.co.uk

* All measurements and distances are approximate Floorplans are for illustration purposes and may not be to scale.



WE'RE **SOLD** ON
YOUR FUTURE



Corum Bearsden
1 Canniesburn Toll, Bearsden, G61 2QU

Tel: 0141 942 5888

Email: bearsdenenq@corumproperty.co.uk

www.corumproperty.co.uk