



**2/1, 12 BATTLEFIELD AVENUE**

**BATTLEFIELD**

[www.corumproperty.co.uk](http://www.corumproperty.co.uk)



**c o r u m**



1 | BEDROOM  
1 | BATHROOM  
1 | PUBLIC ROOM

Occupying a particularly bright position in a popular Southside address, this excellent flat has impressive, fitted storage and a large dining sized kitchen. The property has been very well cared for and upgraded by our client since she took ownership.

- Bright second floor tenement home
- Several amenities in close proximity
- Large bay windowed lounge to front
- Generous double sized bedroom
- Fitted dining kitchen to rear
- Double glazed and gas heating

Amenities

12 Battlefield Avenue is within half a mile of the numerous independent coffee houses, restaurants, bars and shops in the area. Recreational pursuits are available locally at Queens Park or nearby at the Battlefield Community Garden on Arundel Drive where residents of the area regularly socialise. Mount Florida train station is less than half a mile away providing several services an hour into Glasgow central station.

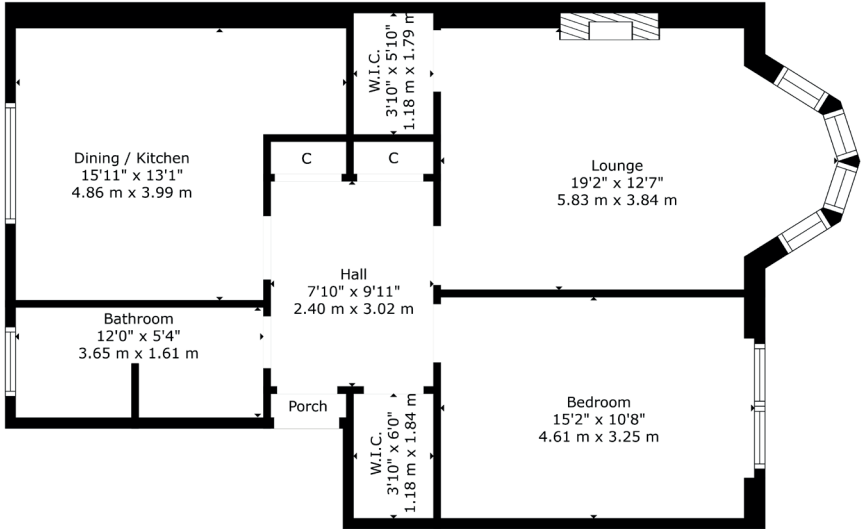

Sat Nav:  
12 Battlefield Avenue, Battlefield, G42 9HP

SS5003

\*All measurements and distances are approximate.  
Floorplans are for illustration purposes and may not be to scale.

For the full home report visit  
[www.corumproperty.co.uk](http://www.corumproperty.co.uk)





WE'RE **SOLD** ON  
YOUR FUTURE



Corum Shawlands  
247 Kilmarnock Road, Shawlands, G41 3JF

**Tel:** 0141 636 7588

**Email:** shawlands@corumproperty.co.uk

[www.corumproperty.co.uk](http://www.corumproperty.co.uk)