



20 CRERAN COURT

PRESTWICK

www.corumproperty.co.uk





2 | BEDROOMS

1 | BATHROOM

1 | PUBLIC ROOM

A gorgeous end terraced villa in the popular town of Prestwick, with immaculate and spacious accommodation, off road parking and private landscaped gardens.

Creran Court forms part of a popular residential area within the seaside town of Prestwick, situated between Adamton Road South and East Road, and ideally placed for access to excellent schools and the amenities of both Prestwick and Ayr. Number 20 is a beautifully presented end terraced villa, with accommodation across two floors that will suit a range of potential purchasers, particularly first time buyers and families. There is spacious living space on the ground floor and two large double bedrooms on the upper floor, with ample storage, quality floor coverings and modern fixtures and fittings throughout. The property also benefits from off road parking at the rear and landscaped gardens to the front and rear that are laid with low-maintenance in mind.

In more detail, the internal accommodation extends to an entrance hallway with a storage cupboard, a spacious lounge with a feature fireplace, a downstairs W.C and a modern fitted dining kitchen with a door out to the rear garden. On the upper floor there is loft access, a large storage cupboard off the landing, a modern fitted family bathroom with a shower over the bath and two large double bedrooms.

Externally the front garden is laid with decorative aggregate and paved pathways, highlighted by shrubs. The rear garden is fully enclosed with gated access out to private residents' parking, monoblock paving and decorative shrubs.



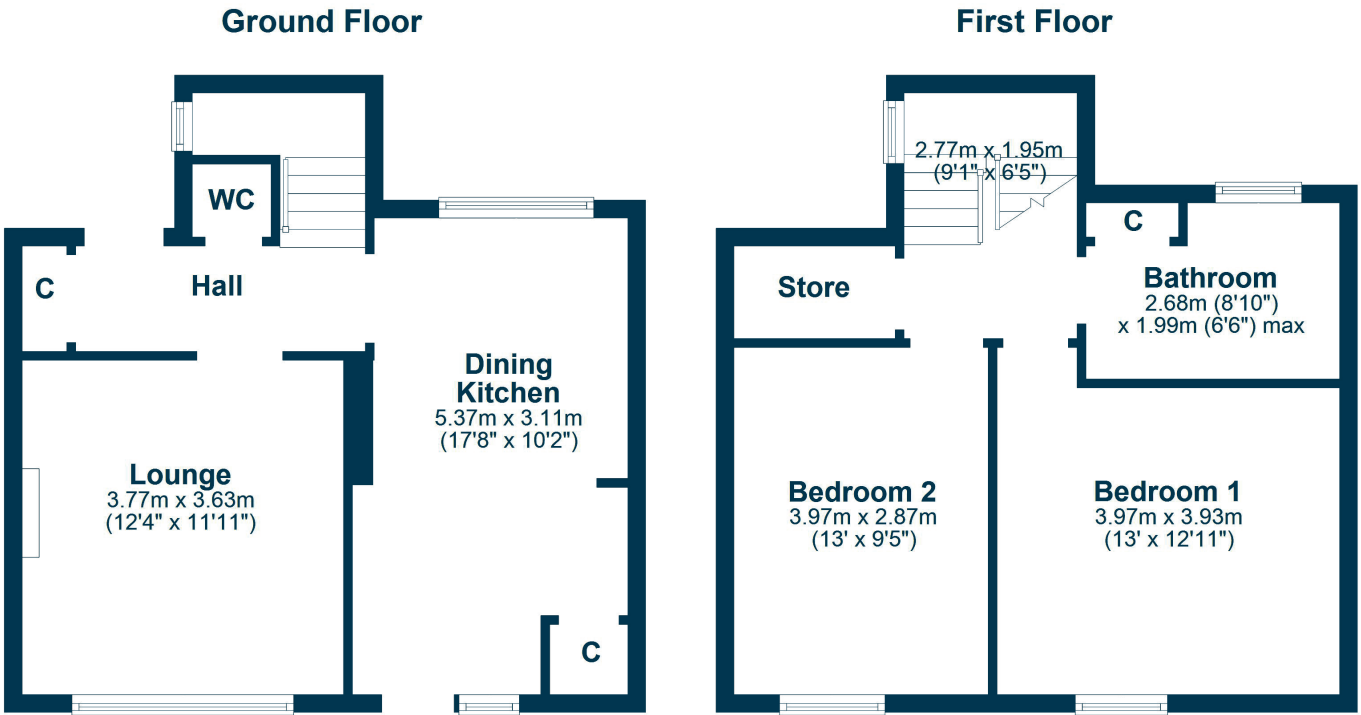

Prestwick is a popular seaside town with a comprehensive range of local amenities, including schools, shops, restaurants and bars, road and rail links to Glasgow and beyond, supermarkets, leisure facilities, first class golf courses and is also home to Prestwick International Airport. A further range of amenities can be found in the nearby market town of Ayr.

AY5221 | Sat Nav: 20 Creran Court, Prestwick, KA9 2LG

For the full home report visit www.corumproperty.co.uk

* All measurements and distances are approximate Floorplans are for illustration purposes and may not be to scale.



WE'RE **SOLD** ON
YOUR FUTURE



Corum Ayr
10 Beresford Terrace, Ayr, KA7 2EG

Tel: 01292 880 888

Email: ayr@corumproperty.co.uk

www.corumproperty.co.uk