



20 MAIN ROAD

AYR

www.corumproperty.co.uk





2 | BEDROOMS

1 | BATHROOM

1 | PUBLIC ROOM

A well presented and spacious ground floor cottage flat with driveway for off-road parking and a generous garden, ideally located just moments from Ayr town centre and Heathfield Retail Park.

Number 20 is a rarely available and spacious ground floor cottage flat. Set within a popular address, this property offers generous all-on-the-level accommodation with modern upgrades to include a stylish shower room and a new boiler.

The property has been renovated and features quality flooring, a fitted kitchen with appliances, a modern shower room, gas central heating, double glazing, and excellent storage.

The internal layout comprises: an entrance vestibule with storage cupboard, a reception hall with storage cupboard, a spacious lounge, a fitted kitchen with ample wall and base units, breakfast bar area, two large double bedrooms (wardrobes included), and the aforementioned shower room.

Externally, the property enjoys a driveway for off-road parking, a timber garage and a generous, rear garden with lawn.

A fantastic opportunity for first-time buyers, downsizers or buy-to-let investors.



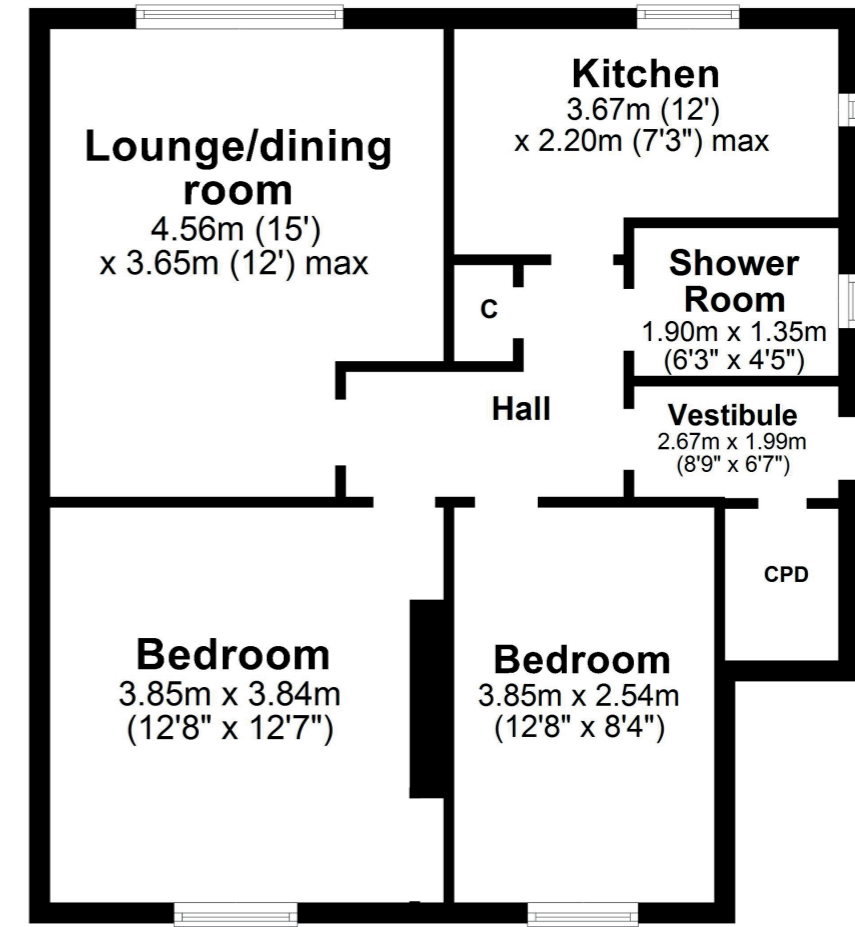

20 Main Road, Ayr, enjoys a fantastic location for everyday amenities and shopping options. Just along the road, a Tesco Supermarket and an ALDI supermarket.

For a broader retail experience, Heathfield Retail Park is just a short drive away. This popular shopping destination features major names like ASDA, M&S Foodhall, Home Bargains, The Range, and B&M, as well as a selection of well-known furniture and electronics stores including Currys, DFS, and Wren Kitchens. There are also several places for fast food, from Costa and Greggs to KFC, Burger King and McDonalds.

Ayr Central Shopping Centre in the town centre offers stores like Primark, H&M, Next, and River Island, along with local cafés as well as Starbucks and Costa.

AY5225 | Sat Nav: 20 Main Road, Ayr, KA8 0LD

For the full home report visit www.corumproperty.co.uk

* All measurements and distances are approximate Floorplans are for illustration purposes and may not be to scale.



WE'RE **SOLD** ON
YOUR FUTURE



Corum Ayr
10 Beresford Terrace, Ayr, KA7 2EG

Tel: 01292 880 888

Email: ayr@corumproperty.co.uk

www.corumproperty.co.uk