



FLAT 1D, LENNOX COURT

18 STOCKIEMUIR AVENUE, BEARSDEN

www.corumproperty.co.uk





1 | BEDROOM

1 | BATHROOM

1 | PUBLIC ROOM

Set within the ever-popular Lennox Court development, in the heart of Bearsden's sought-after Mosshead district, this bright and beautifully presented one-bedroom apartment offers an excellent opportunity for downsizers, first-time buyers or anyone looking for convenient, level-access living. Occupying a desirable ground floor position, the property provides easy access to both the communal entrance and the surrounding landscaped gardens—ideal for those seeking step-free living without compromising on style or setting.

Lennox Court was originally built in the 1960s by respected builders W.S. Gordon, and its enduring appeal lies in a combination of well-proportioned accommodation, mature surroundings, and a location that puts local amenities, transport links and parks all within easy reach. This particular flat is presented in fresh, neutral décor, creating a light and welcoming atmosphere throughout.

The layout includes a spacious reception hallway, with excellent storage, a good sized lounge, that comfortably accommodates both living and dining furniture, a modern fitted kitchen, double bedroom, and a well equipped bathroom, featuring a three-piece suite, with an over-bath shower.

Additional features include:- electric heating, double glazing, a secure entry system, and the services of a property factor overseeing the upkeep of the building and communal areas.

A stylish, easy-living apartment in a quiet Bearsden pocket - perfectly placed for everyday comfort and convenience.



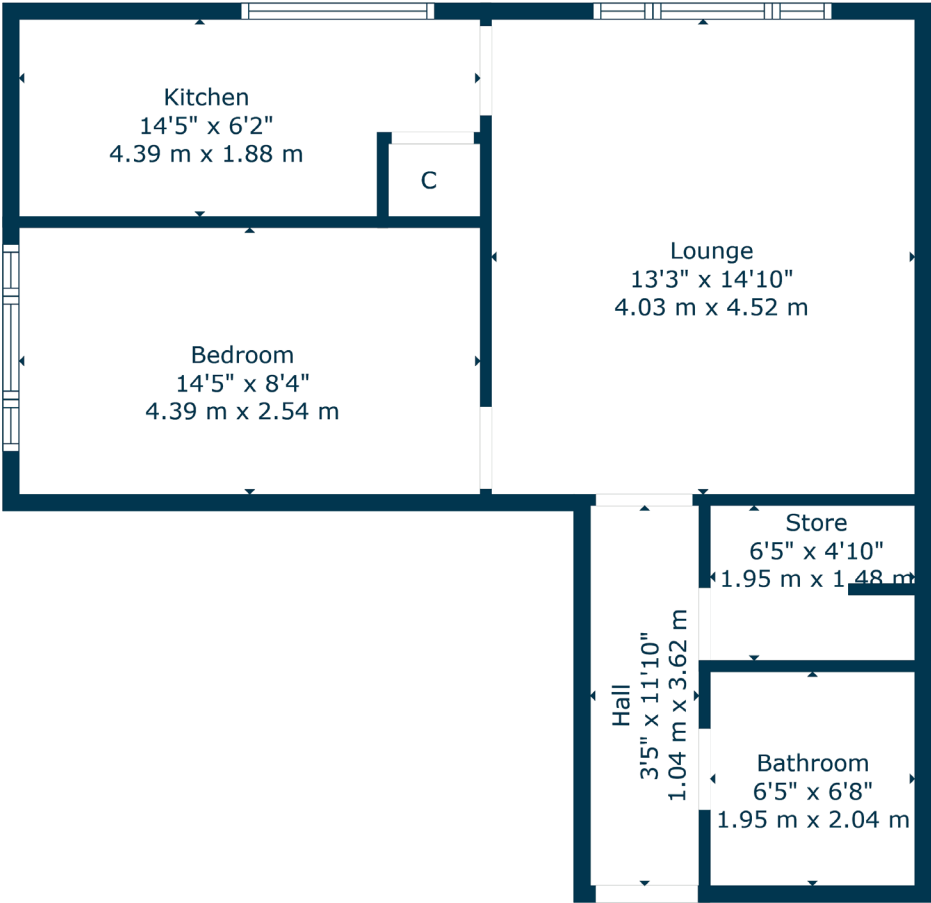

The suburb of Bearsden is one of Glasgow's most desired districts in which to reside. There are numerous highly acclaimed educational facilities at both Primary and Secondary levels and leisure facilities are plentiful with a choice of private and state gyms and clubs in abundance. Locally, there is an excellent selection of shops and services at Bearsden Cross along with restaurants, cafes and bars. There are excellent bus links nearby and train stations can be found at Hillfoot, Westerton and Bearsden providing regular services into Glasgow's West End and City Centre, including a service to Edinburgh.

Glasgow Airport can be reached within twenty-five minutes off peak and, to the north of Bearsden is the world renowned Loch Lomond and The Trossachs National Park.

BD3855 | Sat Nav: Flat 1D, Lennox Court, 18 Stockiemuir Avenue, Bearsden, G61 3JL

For the full home report visit www.corumproperty.co.uk

* All measurements and distances are approximate Floorplans are for illustration purposes and may not be to scale.



WE'RE **SOLD** ON
YOUR FUTURE



Corum Bearsden
1 Canniesburn Toll, Bearsden, G61 2QU

Tel: 0141 942 5888

Email: bearsdenenq@corumproperty.co.uk

www.corumproperty.co.uk